



Connection and tooling solutions

Railway rolling stock
and infrastructure



sicame
GROUP



About us

sicame
GROUP

Sicame Group is one of the key players in the electrical equipment business worldwide. It has been able to adapt and develop to support the continuous evolution of electricity infrastructure in France and around the world, and become the largest independent entity in its sector.

A true player in the energy transition, it offers its customers new products and services to improve energy efficiency, deal with environmental risks and support the development of electric vehicle and solar power plant markets.

+65

years of worldwide success

567 M€

2023 turnover

3.600

employees

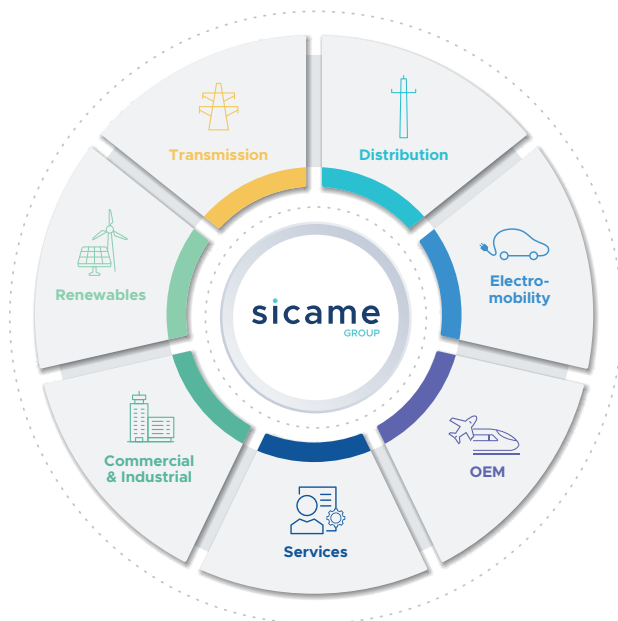

Our fields of activity

Sicame Group is specialised in **products and services** related to transmission and distribution of **electrical energy**, renewables, electro-mobility, safety equipment and industrial applications.

5 continents

26 countries

50 companies
around the world

Products distributed
in 157 countries

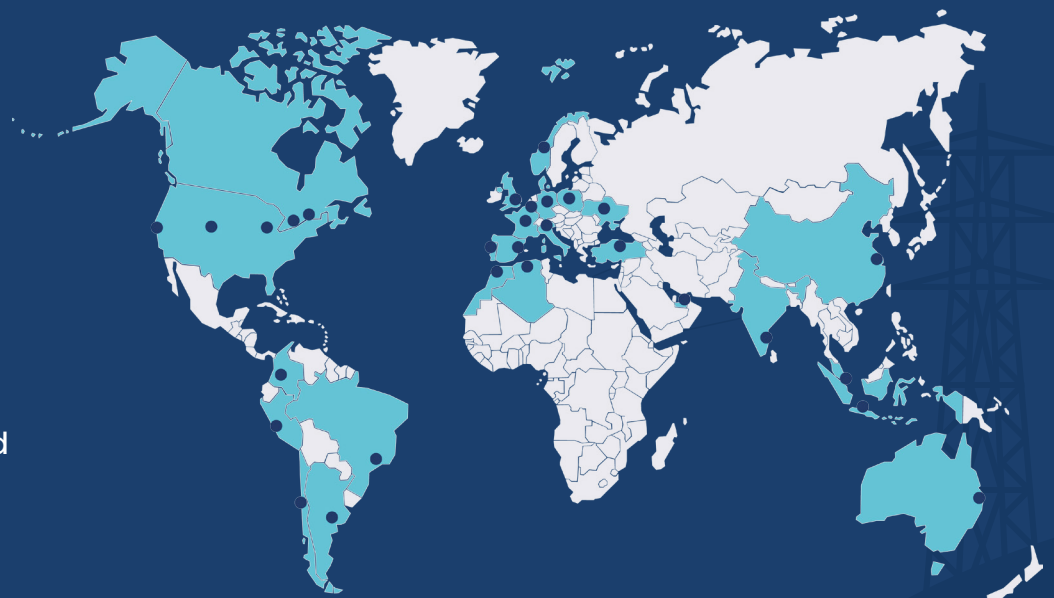

SUMMARY

- **01** p.11
Introduction to connection solutions
- **02** p.19
Terminals for rolling stock
- **03** p.43
Railway infrastructure
- **04** p.46
Signalling and stationary equipment products
- **05** p.53
Tooling



Mecatraction product summary

A _____	P _____
Aluminium tubular lugs 39	Plug-in and plug-out plier 73
C _____	Positioning stoppers 66
Pluggable hydraulic compression head 68/69	Pre-insulated blade and pins terminals 48
Copper butt connectors 51	Pre-insulated butt connectors with inspection window 49
Copper tubular lugs 28/38	Pre-insulated disconnects 2.8 - 5 - 6.35 mm 48
Copper tubular lugs for flexible copper cables with insulation crimping 37	Pre-insulated disconnects 2.8 - 5 and 6.35 and pins terminals for thin insulating conductors according to NFF 63808 ... 26
Copper tubular lugs with axial palm and narrow palm, especially suitable to go through cable glands 36	Pre-insulated disconnects and pins terminals for thin insulating conductors according to EN 50306 24
Cordless electro-mechanical cable-cutter 74	Pre-insulated fork terminals 47
Cutting plier 73	Pre-insulated ring terminals 46
E _____	Pre-insulated terminals for thin insulating conductors according to EN 50306 22
Electro-hydraulic compression tool - 120 kN 64	Pre-insulated terminals for thin insulating conductors according to NFF 63808 26/30
Electro-hydraulic compression tool - 50 kN 62	Pre-insulated terminals from 0.34 to 6 mm ² 20
Electro-hydraulic crimping tool for pre-insulated products 58	Pre-insulated tubular lugs 47
Electro-hydraulic pumps 72	S _____
Electro-hydraulic tool 61	Special copper tubular lugs 38
F _____	T _____
Forged lugs for insulated aluminium cables 44	Two hole copper tubular lugs 35
G _____	
Go-no-go gauge 76	
H _____	
Hand crimping tool 67	
Hand crimping tool for pre-insulated products 56/57	
Hand tool for crimping on edge of pre-insulated products 56	
Hydraulic pumps 71	
L _____	
Low power pre-insulated copper tubular lugs 28	
M _____	
Mechanical crimping tool 59	
Medium power pre-insulated copper tubular lugs 30	

References index

Ref.	page	Ref.	page	Ref.	page	Ref.	page	Ref.	page
51027	48	451081	24	51081-2	21	51195-2NR	28	AL185-16	40
51028	48	451131	24	51081-2	48	51195-4BC	28	AL240-12	40
51032	26	451134	22	51131-2	21	51195R-2NR	46	AL240-14	40
51033	24/26	451135	22	51131-2	48	51195R2NR	28	AL240-16	40
51082	26	451136	22	51134-2	20	51195R4BC	28	AL240-18	40
51083	24/26	451138	22	51135-2	20	51195RR2NR	28	AL240-20	40
51132	26	451143	22	51135-2BC	45	51195RR4BC	28	AL260-14	40
51133	26	451153	22	51136-2	20	51196-2NR	28	AL260-16	40
51182	26	451154	22	51136-2	45	51196-2NR	46	AL260-18	40
51183	24/26	451155	22	51136-2BC	45	51196-4BC	28	AL300-14	40
51232	26	451174	23	51138-2	20	51198-2NR	28	AL300-16	40
51233	26	451175	23	51143-2	20	51198-2NR	46	AL300-18	40
51328	48	451176	23	51143-2	45	51198-4BC	28	AL300-20	40
51391	27/49	451178	23	51143-2BC	45	51220-2	21	AL460-16	40
51402	27/49	451181	24	51153-2	20	51220-2	48	AL460-18	40
51413	27/49	451183	23	51153R-2	20	51220-2 BC	48	AL460-20	40
251134	25	451184	23	51154-2	20	51222-2	21	AL460-22	40
251135	25	451185	23	51154-2	45	51222-2	48	AL460-24	40
251136	25	451220	24	51154-2BC	45	51223-2 JN	48	AL50-10	39
251138	25	451231	24	51154R-2	20	51223-2JN	21	AL50-12	39
251153	25	551031	24	51155-2	20	51223-4J	21	AL50-6	39
251154	25	551081	24	51155-2	45	51225-2	21	AL50-8	39
251155	25	551131	24	51161-2NR	21	51225-2	48	AL60-10	39
251174	25	551134	22	51161-4BC	21	51225-2 BC	48	AL60-12	39
251175	25	551135	22	51174-2	20	51226-2	21	AL60-8	39
251176	25	551136	22	51175-2	20	51226-2	48	AL70-10	39
251178	25	551138	22	51176-2	20	51227-2 JN	48	AL70-12	39
251183	25	551143	22	51176-2	45	51227-2G	48	AL70-8	39
251184	25	551153	22	51178-2	20	51227-2JN	21	AL95-10	39
251185	25	551154	22	51178-2	45	51227-4J	21	AL95-12	39
251220	26	551155	22	51181-2	21	51231-2	21	AL95-14	39
351134	22	551174	23	51181-2	48	51231-2	48	AL95-8	39
351134	25	551175	23	51183-2	20	51261-2NR	21	B2XV32	72
351135	22	551176	23	51183-2	45	51261-2NR	48	BL1820I	61
351135	25	551178	23	51183R-2	20	51261-4BC	21	BL1850B	63/65/74
351136	22	551181	24	51184-2	20	51661-2JN	21	C100-251134	25
351136	25	551183	23	51184-2	45	51661-4J	21	C100-251135	25
351138	22	551184	23	51184R-2	20	53226-2 NR	48	C100-251136	25
351138	25	551185	23	51185-2	20	53226-2 R	48	C100-251138	25
351143	22	551220	24	51185-2	45	551153R	22	C100-251153	25
351153	22	551231	24	51193-2NR	28	551154R	22	C100-251153R	25
351153	25	251153R	25	51193-4BC	28	551183R	23	C100-251154	25
351154	22	251154R	25	51193R-2NR	46	551184R	23	C100-251154R	25
351154	25	251183R	25	51193R2NR	28	AL120-10	39	C100-251155	25
351155	22	251184R	25	51193R4BC	28	AL120-12	39	C100-251174	25
351155	25	351153R	22	51193RR2NR	28	AL120-14	39	C100-251175	25
351174	25	351153R	25	51193RR4BC	28	AL150 B-14	39	C100-251176	25
351175	25	351154R	22	51193RRS4BC	28	AL150 B-16	39	C100-251178	25
351176	25	351154R	25	51194-2NR	28	AL150 B-18	39	C100-251183	25
351178	25	351183R	25	511944BC	28	AL150-10	39	C100-251183R	25
351183	25	351184R	25	51194R-2NR	46	AL150-12	39	C100-251184	25
351184	25	451153R	22	51194R2NR	28	AL150-14	39	C100-251184R	25
351185	25	451154R	22	51194R4BC	28	AL150-16	39	C100-251185	25
351220	24	451183R	23	51194RR2NR	28	AL185-10	40	C100-251220	26
351220	26	451184R	23	51194RR4BC	28	AL185-12	40	C100-351134	22 /25
451031	24	51031-2	21	51194RRS4BC	28	AL185-14	40	C100-351135	22 /25



References index

Ref.				
C100-351136 22 /25	C100-51136-2..... 20	C100-51232..... 26	C100C3P50NUE 31	ELS460 ou C12 ELS . 65
C100-351138 22 /25	C100-51138-2..... 20	C100-51233..... 26	C100C3P60NUE 31	ELS50 31
C100-351143 22	C100-51143-2..... 20	C100-51261-2NR 21	C100C3P80NUE 31	ELS50 50
C100-351153 22 /25	C100-51153-2..... 20	C100-51261-4BC 21	C12TN120 65	ELS60 31
C100-351153R..... 22 /25	C100-51153R-2 20	C100-51391..... 27	C12TN150 65	ELS60 50
C100-351154 22 /25	C100-51154-2..... 20	C100-51402 27	C12TN185 65	ELS80 31
C100-351154R..... 22 /25	C100-51154R-2 20	C100-51413..... 27	C12TN240 65	ELS80 50
C100-351155 22 /25	C100-51155-2..... 20	C100-51661-2JN 21	C12TN25..... 65	ELSU40 31
C100-351174 25	C100-51161-2NR 21	C100-51661-4J 21	C12TN35..... 65	ELSU50 31
C100-351175 25	C100-51161-4BC 21	C100-551031..... 24	C12TN50..... 65	ESD50..... 63
C100-351176 25	C100-51174-2..... 20	C100-551081..... 24	C12TN70..... 65	ESD50K1BLCM..... 63
C100-351178 25	C100-51175-2..... 20	C100-551131..... 24	C12TN95..... 65	ESK50K1BLCP..... 74
C100-351183 25	C100-51176-2..... 20	C100-551134 22	C3P40-2JN 29	ESPU50 30
C100-351183R..... 25	C100-51178-2..... 20	C100-551135 22	C3P40-4J 29	ESU137 65
C100-351184 25	C100-51181-2..... 21	C100-551136 22	C3P40R2JN..... 29	ESU137K1BLCM..... 65
C100-351184R..... 25	C100-51182..... 26	C100-551138 22	C3P40R4J..... 29	ET300K1BLCM..... 58
C100-351185 25	C100-51183..... 24	C100-551143 22	C3P40RR2JN 29	F4622K..... 72
C100-351220 24	C100-51183..... 26	C100-551153 22	C3P40RR4J 29	F4623K..... 72
C100-351220 26	C100-51183-2..... 20	C100-551153R..... 22	C3P40RRS4J..... 29	F4626K..... 72
C100-451031..... 24	C100-51183R-2 20	C100-551154 22	C3P50-2JN 29	FLP100..... 30
C100-451081..... 24	C100-51184-2..... 20	C100-551154R..... 22	C3P50-4J 29	FLP120 30
C100-451131 24	C100-51184R-2 20	C100-551155 22	C3P50R2JN..... 29	FLP460..... 65/67
C100-451134 22	C100-51185-2..... 20	C100-551174 23	C3P50R4J..... 29	FLP50 30
C100-451135 22	C100-51193-2NR 28	C100-551175 23	C3P50RR2JN 29	FLP60 30
C100-451136 22	C100-51193-4BC 28	C100-551176 23	C3P50RR4J 29	FLP80 30
C100-451138 22	C100-51193R2NR 28	C100-551178 23	C3P60-2JN 29	FLPU50 30
C100-451143 22	C100-51193R4BC 28	C100-551181 24	C3P60-4J..... 29	FLS100..... 31/50
C100-451153 22	C100-51193RR2NR... 28	C100-551183 23	C3P80-2JN 29	FLS120 31/50
C100-451153R..... 22	C100-51193RR4BC... 28	C100-551183R..... 23	C3P80-4J..... 29	FLS460..... 67
C100-451154 22	C100-51193RRS4BC . 28	C100-551184 23	C4P60-2G..... 46	FLS460 ou C12 FLS . 65
C100-451154R..... 22	C100-51194-2NR 28	C100-551184R..... 23	C4P80-2G..... 46	FLS50 31
C100-451155 22	C100-511944BC..... 28	C100-551185 23	CH1830HC..... 61	FLS60 31/50
C100-451174 23	C100-51194R2NR 28	C100-551220 24	CLM1890HC..... 63	FLS80 31/50
C100-451175 23	C100-51194R4BC 28	C100-551231 24	CLM1890HC..... 63	FLSU50 31
C100-451176 23	C100-51194RR2NR ... 28	C100-C3P40-2JN 29	CLM1890HC..... 65	H1-10-35F 59/63
C100-451178 23	C100-51194RR4BC ... 28	C100-C3P40-4J..... 29	CLM1890HC..... 65	H1-16-50F 59/63
C100-451181..... 24	C100-51194RRS4BC . 28	C100-C3P40R2JN..... 29	CLM1890HC..... 74	H1-25-70F 59/63
C100-451183 23	C100-51195-2NR 28	C100-C3P40R4J..... 29	CM3EID51..... 61	HF95X..... 72
C100-451183R..... 23	C100-51195-4BC 28	C100-C3P40RR2JN . 29	CMES120KN 65	HS6000..... 73
C100-451184 23	C100-51195R2NR 28	C100-C3P40RR4J 29	CMESD50 63	KCHTA10F14BSP 70
C100-451184R..... 23	C100-51195R4BC 28	C100-C3P40RRS4J.. 29	EID51 61	KCHTA10M38NPT ... 70
C100-451185 23	C100-51195RR2NR ... 28	C100-C3P50-2JN 29	EID51KCM..... 61	MJ1.5 51
C100-451220 24	C100-51195RR4BC... 28	C100-C3P50-4J..... 29	ELP100 30	MJ10SH..... 51
C100-451231 24	C100-51196-2NR 28	C100-C3P50R2JN... 29	ELP120 30	MJ16SH..... 51
C100-51031-2..... 21	C100-51196-4BC 28	C100-C3P50R4J..... 29	ELP40 30	MJ2.5 51
C100-51032 26	C100-51198-2NR 28	C100-C3P50RR2JN . 29	ELP460..... 65	MJ25SH 51
C100-51033 22 /25	C100-51198-4BC 28	C100-C3P50RR4J ... 29	ELP460..... 67	MJ35SH 51
C100-51081-2 21	C100-51220-2..... 21	C100-C3P60-2JN 29	ELP50 30	MJ3S 51
C100-51082 26	C100-51222-2..... 21	C100-C3P60-4J..... 29	ELP60 30	MJ50SH..... 51
C100-51083 24	C100-51223-2JN..... 21	C100-C3P80-2JN 29	ELP80 30	MJ70SH..... 51
C100-51083 26	C100-51223-4J..... 21	C100-C3P80-4J..... 29	ELPU40 30	MJTN120 51
C100-51131-2..... 21	C100-51225-2..... 21	C100-STC2-10-2JN . 20	ELPU50 30	MJTN150 51
C100-51132..... 26	C100-51226-2..... 21	C100-STC2-10-4J 20	ELS100..... 31/50	MJTN185 51
C100-51133..... 26	C100-51227-2JN..... 21	C100-STC2-8-2JN... 20	ELS120 31/50	MJTN240 51
C100-51134-2..... 20	C100-51227-4J..... 21	C100-STC2-8-4J..... 20	ELS40 31/50	MJTN95..... 51
C100-51135-2..... 20	C100-51231-2..... 21	C100C3P40NUE..... 31	ELS460..... 67	MO-66105 73

Ref.	
MO66200	73
NP100	30
NP120	30
NP460	65/67
NP50	30
NP60	30
NP80	30
PA133K	71
PG1	76
PG2	76
PGH3	76
PGM1	59/76
PGN10	76
PGN16	76
PGP10	76
PGP16	76
PGP25	76
PGTN125	76
PGTN150	76
PGTN185	76
PGTN240	76
PGTN25	76
PGTN300	76
PGTN35	76
PGTN50	76
PGTN60	76
PGTN70	76
PGTN95	76
PMM1CF	59
RFKM38NPT	72
RMKF38NPT	72
SPM4095K	71
SPT21-585KCM	72
STC 1-4-2JN	45
STC 1-5-2JN	45
STC 1-6-2JN	45
STC 2-10-2JN	45
STC 2-12-2JN	45
STC 2-8-2JN	45
STC2-10-2JN	20
STC2-10-4J	20
STC2-8-2JN	20
STC2-8-4J	20
STRGFA1-3-2	46
STRGFA2-4-2	46
STRGFA2-4-2BC	46
STRGFA2-5-2	46
STRGFB1-3-2	46
STRGFB1-4-2	46
STRGFB2-5-2	46
STRGFC1-4-2JN	46
STRGFC1-5-2JN	46
STRGFC1-6-2JN	46
SU130K	68
SU210K	69
TH1	56
TH1-90	56
TH1S	56
TH2	57
TH2S	57
TH3	57
TH3-2	57
TN120-10	33
TN120-10	66
TN120-10-24	35
TN120-10-25.4	35
TN120-10-29	35
TN120-10-34	35
TN120-12	33
TN120-12	66
TN120-14	33
TN120-14	66
TN120-16	33
TN120-16	66
TN120-8	33
TN150-10	33
TN150-10-25.4	35
TN150-12	33
TN150-14	33
TN150-16	33
TN150-18	33
TN150-8	33
TN185-10	33
TN185-12	33
TN185-14	33
TN185-16	33
TN185-18	33
TN240-10	33
TN240-10-25.4	35
TN240-12	33
TN240-14	33
TN240-16	33
TN240-18	33
TN240-20	33
TN25-10	32
TN25-10	50
TN25-10	66
TN25-12	50
TN25-14	32
TN25-14	50
TN25-460	67
TN25-5	32
TN25-5	50
TN25-5	66
TN25-6	32
TN25-6	50
TN25-6	66
TN25-8	32
TN25-8	50
TN25-8	66
TN300-16	33
TN300-18	33
TN300-20	33
TN300-22	33
TN35-10	32
TN35-10	50
TN35-10	66
TN35-12	50
TN35-460	67
TN35-6	32
TN35-6	50
TN35-6	66
TN35-8	32
TN35-8	50
TN35-8	66
TN50-10	32
TN50-10	50
TN50-10	66
TN50-10-24	35
TN50-10-29	35
TN50-10-34	35
TN50-12	32
TN50-12	50
TN50-12	66
TN50-14	32
TN50-14	50
TN50-460	67
TN50-6	32
TN50-6	50
TN50-6	66
TN50-8	32
TN50-8	50
TN50-8	66
TN60-10	32
TN60-10	66
TN60-12	32
TN60-12	66
TN60-6	32
TN60-6	50
TN60-8	32
TN60-8	66
TN70-10	32
TN70-10	50
TN70-10	66
TN70-10-24	35
TN70-10-25.4	35
TN70-10-29	35
TN70-10-34	35
TN70-12	32/50/66
TN70-14	32/50
TN70-16	32/50
TN70-460	67
TN70-6	32/50
TN70-8	32/50/66
TN95-10	32/50
TN95-10-24	35
TN95-10-25.4	35
TN95-10-29	35
TN95-10-34	35
TN95-12	32/50
TN95-14	32/50
TN95-16	32
TN95-460	67
TN95-6	32
TN95-8	32
TR120-10	34
TR120-12	34
TR120-14	34
TR120-16	34
TR120-18	34
TR1461	67
TR150-10	34
TR150-12	34
TR150-14	34
TR150-16	34
TR150-18	34
TR150-20	34
TR185-12	34
TR185-14	34
TR185-16	34
TR185-18	34
TR185-20	34
TR185-22	34
TR240-16	34
TR240-18	34
TR240-20	34
TR240-22	34
TR300-16	34
TR300-18	34
TR300-20	34
TR300-22	34
TR300-24	34
TR400-24	34
TR500-30	34
TR95-10	34
TR95-12	34
TR95-14	34
TR95-16	34
TR95-18	34
TRS120-12-90E	38
TRS150-12	35
TRS150-12-90E	38
TRS150-16-90E	38
TRS185	35
TRS185-12-90E	38
TRS185-1B	38
TRS240	35
TRS240-16-90E	38
TRS240-1B	38
TRS242-12	38
TRS243-10	37
TRS243-10EXP	37
TRS243-8	37
TRS243-8EXP	37
TRS244-10	37
TRS244-10EXP	37
TRS244-12	37
TRS244-12EXP	37
TRS245-10	37
TRS245-10EXP	37
TRS245-12	37
TRS245-12EXP	37
TRS246	37/38
TRS246-10	37
TRS246-10-25	38
TRS246-10EXP	37
TRS246EXP	37
TRS247	38
TRS262	38
TRS400	35
TRS446-10	36
TRS446-12	36
TRS446-14	36
TRS448-10	36
TRS448-12	36
TRS448-14	36
TRS450	36
TRS450-14	36
TRS452	36
TRS452-12	36
TRS452-16	36
TRS452OBL	36
TRS455	36
TRS455-12PE	36
TRS95-10	36
TRS95-12	36
TRS95-12-90E	38
TRS95-16-90E	38
VF130K	68
VF210K	69
Y4CA075A22M12HTN15	44
Y4CA075A22M12TN15	44
Y4CA075A22M16HTN15	44
Y4CA075A22M16TN15	44
Y4CA110A22M12HTN15	44
Y4CA110A22M12TN15	44
Y4CA110A22M16HTN15	44
Y4CA110A22M16TN15	44

Services for railway solutions

TENSILE TESTING

Checks and verifications on crimped specimens:

- Visual inspection of crimping indentations.
- Pull-out tests.
- A report on crimped samples is issued.

MACROGRAPHIC SECTION

Sections and checks on crimped specimens:

- Visual inspection of crimping indentations as per RCCE-E4000.
- Filling coefficient as per RCCE-E4000.

MAINTENANCE AND INSPECTION OF DIES

- Visual inspection.
- Dimensional inspection.
- Polishing.
- Production of a test piece.
- An inspection report will be issued.

INSPECTION AND MAINTENANCE SERVICE

We provide inspection and maintenance services for tools, either in the factory or on the customer's site.

TOOLING

- Crimping tools inspection and maintenance.
- Cable cutters.
- Shears and hydraulics.
- Cable preparation tools for LV equipment.

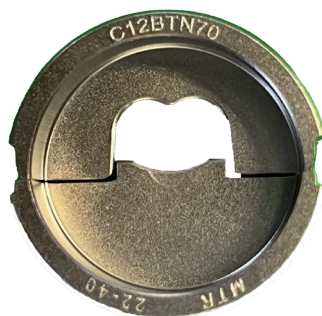



TRAINING

Training courses tailored to your needs:

- Railway connectors, tooling and crimping.
- Electrical safety.

SITE AUDIT AND INVESTIGATIVE TESTING

For further information about our services:

Mr Alexandre Porte

Railway OEM Market Development Manager & Product technical Support Manager

alexandre.porte@mecatraction.com

Ms. Solène Mestre

Services Portfolio Manager

smestre@sicamegroup.com



01

I Introduction to connection solutions



Solutions connections

A dynamic company

Founded in 1981. MECATRACTION has enjoyed rapid growth in France and abroad. Based in POMPADOUR, in the Corrèze region of France, on a site of over 8.100 m². MECATRACTION designs, develops and manufactures a complete range of industrial electrical connections, wiring accessories and a wide range of installation tools.

MECATRACTION is a subsidiary of the SICAME GROUP

The SICAME GROUP specializes in accessories for the transport and the transmission of electrical power.

Your best partner in the high-tech sector

MECATRACTION has forged a position for itself in many sectors of industry that demand know-how, precision and efficiency through the quality of our products and our capacity for innovation.

These sectors include the rail, automotive, aeronautic, space, nuclear, renewable energies, shipping and defence industries.



High means of production

The manufacturing of components for electrical connections requires a production apparatus both modern and extremely flexible.

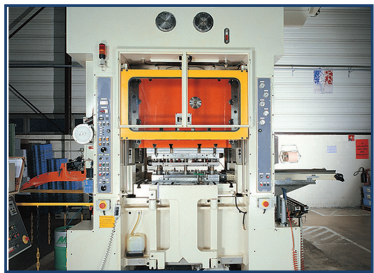

Research & Development

Our Research and Development department is composed of multi-disciplinary teams who combine creativity and reactivity.

Working closely with our customers, this organization offers innovative co-developed solutions. These products are prototyped and qualified in our test laboratory.

Our design office is equipped with state-of-the-art CAD tools (Pro/Engineer - Pro-Mechanica - Visy-Progress...).

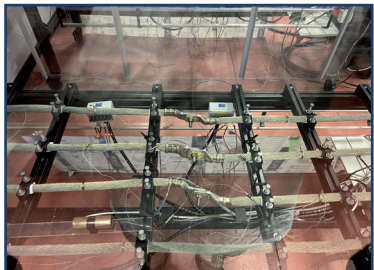
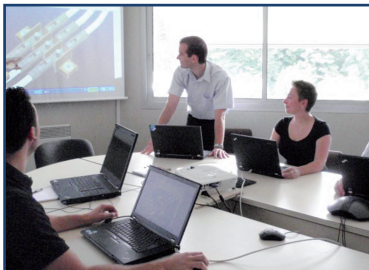

Quality and Environment



Customized products

For any information on special ranges and customized manufacturing: please contact us.

Automotive electrical connections



Aeronautics electrical connections



Expanded copper tubular lugs for crimping on core and insulation



Customized electrical connections



Tubular lugs bent right or left

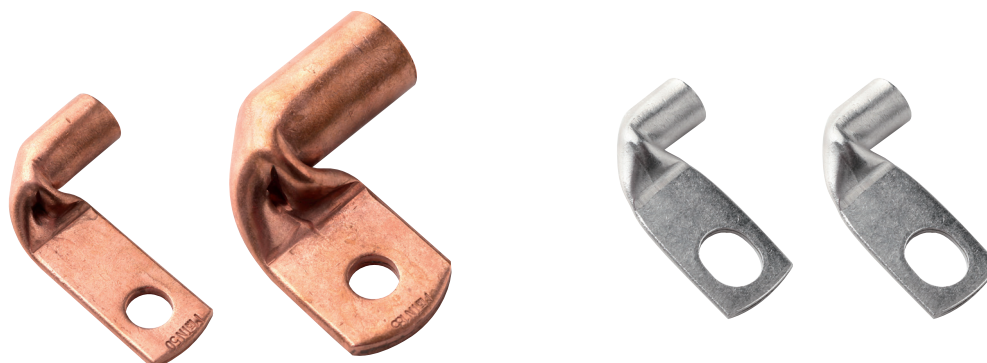

Key rules for crimping

The 4 key elements:

- An electrical connection must be electrically and mechanically sound. A complete system (terminal block, electric motor, automation, lighting...) depends upon the quality of this connection.

- In order to ensure the integrity of the final assembly (5), the product, the preparation, and the crimping operations should be implemented according to the key rules and by taking into account the first 4 essential key elements:

1. A quality crimp termination suited to the application.



2. An electric cable correctly stripped and matched to the application.

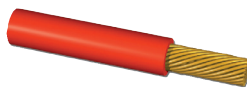

3. A quality crimping tool matched to both termination and conductor.



4. An operator with experience in crimping techniques.



General features of a crimped electrical connection:

A crimped electrical connection provides the link between a cable and the electrical equipment.

The main features of these connections are:

- **Excellent conductivity**
- **Good tensile strength**
- **Good corrosive resistance**
- **Good resistance to vibration**
- **No voltage drop or rise in temperature**

Qualification of a crimped termination:

- Mechanical tests.

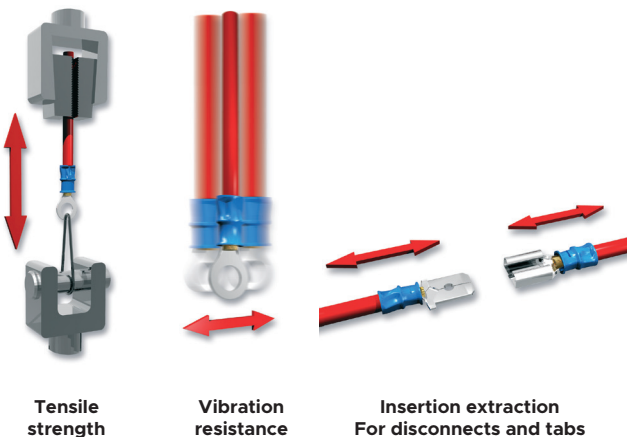

- Electrical tests.

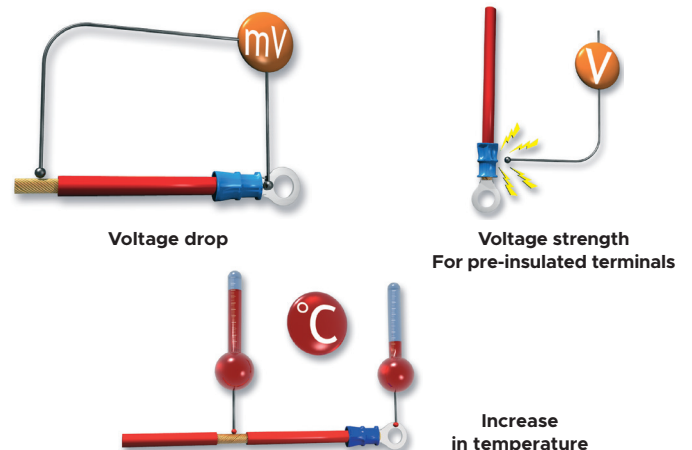

Crimping of pre-insulated terminals

Types of pre-insulated terminals “single crimp” and “double crimp”. “Double crimp” type is particularly suited to electrical connections suffering stress or vibrating stress.

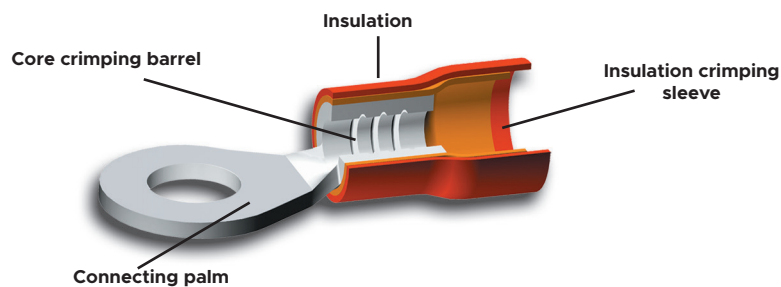

Cables

Cable correctly stripped:

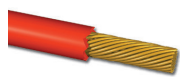
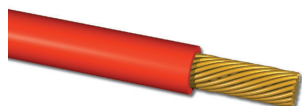

✗ Insulation poorly stripped



✗ Cable strands damaged or cut

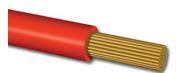

✗ Cable strands not twisted

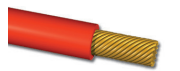

✗ Cable strands over twisted

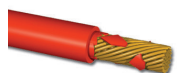

✗ Insulation particles on cable core

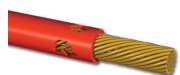

✗ Cable insulation damaged

Crimping

Terminal correctly crimped:



✗ Conductor insufficiently stripped

✗ Crimped off centre

✗ Crimped too far forward

✗ Tool presented incorrectly

✗ Cable over stripped. difficult to assemble on the tab



Key rules for crimpings

Crimping of copper tubular lugs:

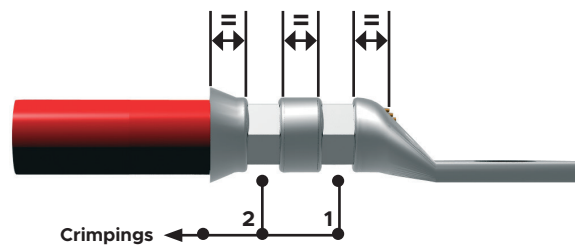
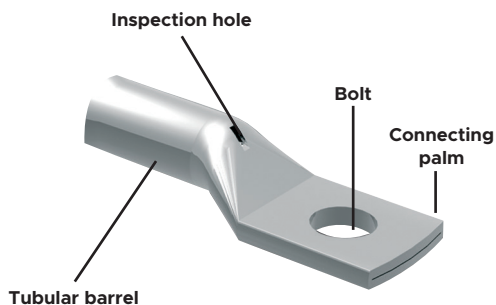

Cables

Cable correctly stripped:

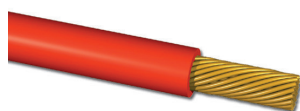

✗ Insulation poorly stripped



✗ Cable strands damaged or cut

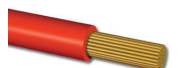

✗ Cable strands not twisted

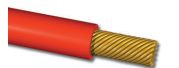

✗ Cable strands over twisted



✗ Insulation particles on cable core



✗ Cable insulation damaged

Crimping

Terminal correctly crimped:

1. Cable strands viewed through inspection hole.
2. Cable correctly stripped and sufficiently introduced into the barrel.
3. Crimping mark correctly centred on the barrel.

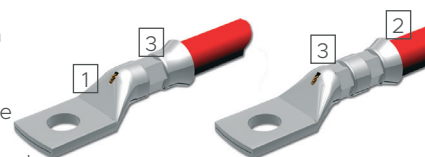

✗ Cable not fully inserted

✗ Crimped off center

✗ Crimped off centre

✗ Incorrect or damaged die. handles appear

✗ Crimps incorrectly positioned



Technical support for tooling

MTR
Sicame Group

Our technical and commercial department can provide you with technical support services adapted to your needs

Demonstration

-

Maintenance / repair

-

Commissioning

-

Control / verification on site or in our factory

-

Training on crimping techniques

Please feel free to contact us by e-mail:
service.technico@mecatraction.com
www.mecatraction.com



Blue stopper. The controlled crimping!

These mobile stoppers compatible with TN railway lugs from 25 to 120 mm².

These accessories fit our ESU137 and VF210 tools and ensure the crimp is positioned in the middle of the terminal. Our new solution guarantees productivity and repeatability.

- Reduces the time taken to crimp in series by up to 50%
- Reduced scrap
- Assurance of quality crimping
- Relief for the operator



Scan to see the
presentation video

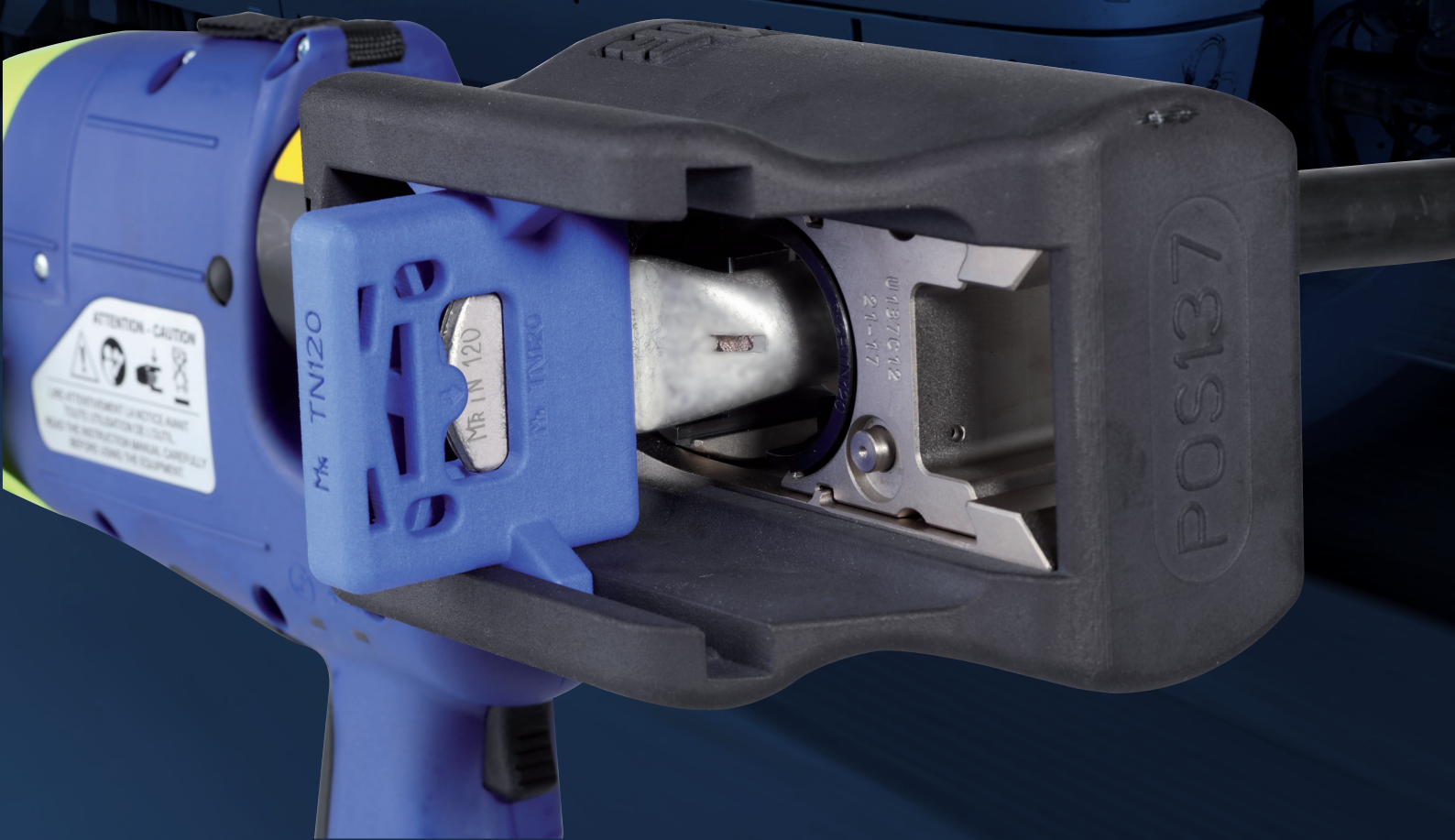
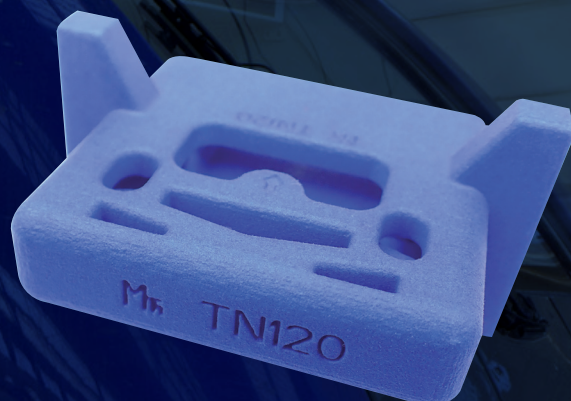

02

I Terminals for rolling stock

**Pre-insulated terminals, disconnects
and pins**

P. 20

Copper tubular lugs

P. 31

Aluminium tubular lugs

P. 39

Pre-insulated terminals from 0.34 to 6 mm²

- Material: tin-plated copper.
- Insulation according to EN 45545.
- Suitable for copper cables according NFF or EN standards.
- SNCF drawing: 10-5050-309 / 10-5206-826.
- RATP drawing: MR-3-52964.

For packaging by 100, add C100- before the reference.

Standards:

NFF 00363

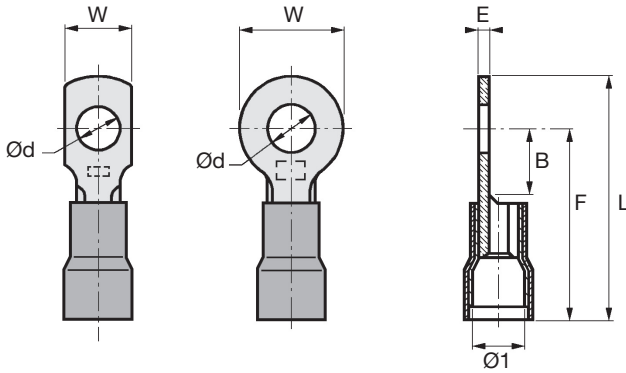

Cross section (mm ²)	Ref.	W	L	E	Ø d	F	B	Ø 1	SNCF code	Crimping tool
0.34 - 1.5	● 51143-2	5.6	17.3	0.80	3.2	14.5	3.5	3.6	7-847-4839	TH1 or TH1S
	51153-2	8	21	0.80	3.2	17	6	3.6	7-847-5643	
	51153R-2	6.5	20.5	0.80	3.2	16.5	5.5	3.6	7-847-5603	
	51154-2	8	21	0.80	4.2	17	6	3.6	7-847-5028	
	51154R-2	6.5	20.5	0.80	4.2	16.5	5.5	3.6	7-847-4654	
	51155-2	8	21	0.80	5.2	17	6	3.6	7-847-1112	
	51134-2	12.5	27	0.80	4.2	20.7	6.5	3.6		
	51135-2	12.5	27	0.80	5.2	20.7	6.5	3.6	7-847-4586	
	51136-2	12.5	27	0.80	6.3	20.7	6.5	3.6	7-847-4251	
	51138-2	12.5	27	0.80	8.4	20.7	6.5	3.6		
1 - 2.5	● 51183-2	8.6	21	0.80	3.2	16.7	6	4.8	7-847-5237	TH2 or TH2S
	51184-2	8.6	21	0.80	4.2	16.7	6	4.8	7-847-5532	
	51185-2	8.6	21	0.80	5.2	16.7	6	4.8	7-847-5483	
	51174-2	12.5	27	0.80	4.2	20.7	6	4.8		
	51175-2	12.5	27	0.80	5.2	20.7	6	4.8	7-847-5602	
	51176-2	12.5	27	0.80	6.3	20.7	6	4.8	7-847-5484	
	51178-2	12.5	27	0.80	8.4	20.7	6	4.8	7-847-4678	
	51183R-2	6.4	20.5	0.80	3.2	16.5	5.5	4.8	7-847-4426	
	51184R-2	6.4	20.5	0.80	4.2	16.5	5.5	4.8	7-847-4250	
Note: part number with "R" suffix are square terminals.										
2.6 - 6	● STC2-8-4J	13.8	32.5	1	8.3	25.5	8	6.8	7-847-4215	TH3
	STC2-10-4J	13.8	32.5	1	10.3	25.5	8	6.8	7-847-4485	
2.6 - 6	● STC2-8-2JN	13.8	35	1	8.3	28	8	8.8	7-847-4363	TH3-2
	STC2-10-2JN	13.8	35	1	10.3	28	8	8.8	7-847-5390	

Unless otherwise stated, all dimensions are in millimeters.

Pre-insulated cable terminals for thin-wire conductors according to NFF 63808

- Material for disconnects: tin-plated phosphorous bronze.
- Material for pin and blade terminals: tin-plated copper.
- Insulation according to EN 45545.
- Suitable for copper cables according NFF or EN standards.
- SNCF drawing: 10-5050-310.
- RATP drawing: MR-3-52965.

For packaging by 100, add C100- before the reference.

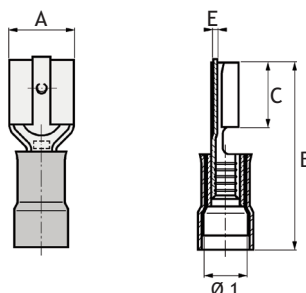

Pre-insulated reinforced disconnects

Pre-insulated disconnects: 2.8 - 5 and 6.35 mm

Cross section (mm ²)	Ref.	For tabs (l x e)	A	B	C	Ø 1	E	SNCF code	Crimping tool
0.34 - 1.5	● 51031-2	2.8 x 0.5	3.7	18.5	6.5	3.6	0.25	7-847-1903	
	● 51081-2	5 x 0.8	6.4	21	7.7	3.6	0.5	7-847-4728	TH1 ou TH1S
	● 51181-2	6.35 x 0.8	7.7	21	7.7	3.6	0.5	7-847-4700	
1 - 2.5	● 51131-2	5 x 0.8	6.4	21	7.7	4.8	0.5	7-847-4999	TH2 ou TH2S
	● 51231-2	6.35 x 0.8	7.7	20.2	7.7	4.8	0.5	7-847-4797	
	○ 51161-4BC	5 x 0.8	6.4	25	7.7	6.8	0.5	7-847-4994	TH3
	● 51161-2NR	5 x 0.8	6.4	27.5	7.7	8.8	0.5		TH3-2
	○ 51261-4BC	6.35 x 0.8	7.7	25	7.7	6.8	0.5	7-847-5070	TH3
	● 51261-2NR	6.35 x 0.8	7.7	27.5	7.7	8.8	0.5	7-847-6798	TH3-2
2.6 - 6	● 51661-4J	6.35 x 0.8	7.7	25	7.7	6.8	0.5		TH3
	● 51661-2JN	6.35 x 0.8	7.7	25	7.7	8.8	0.5	7-847-5237	TH3-2

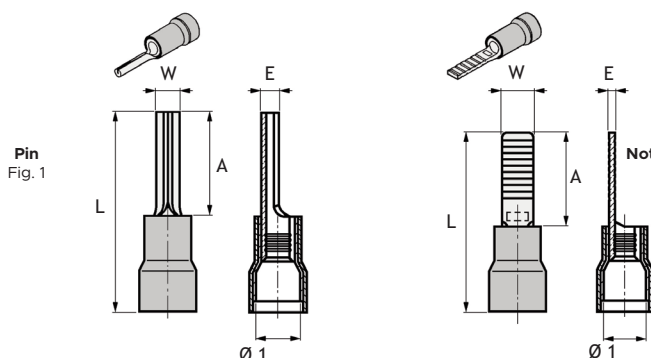

Pre-insulated reinforced end caps

Pre-insulated cable pins and blade terminals

Cross section (mm ²)	Ref.		W	A	L	Ø 1	E	SNCF code	Crimping tool
0.34 - 1.5	● 51220-2	Fig. 1	1.6	12	22.5	3.6	1.9	7-847-5051	
	● 51225-2	Fig. 2	2.9	11.3	21	3.6	0.8	7-847-5556	TH1 or TH1S
1 - 2.5	● 51222-2	Fig. 1	1.8	12	22	4.8	1.8	7-847-5002	TH2 or TH2S
	● 51226-2	Fig. 2	3.9	12	22	4.8	0.8	7-847-5555	
2.6 - 6	● 51223-4J	Fig. 1	2.5	14	28	6.8	2.5	7-847-5003	TH3
	● 51227-4J	Fig. 2	3.9	13	26.5	6.8	1.0	7-847-5561	
2.6 - 6	● 51223-2JN	Fig. 1	2.5	14	28	8.8	2.5	7-847-5393	TH3-2
	● 51227-2JN	Fig. 2	3.9	13	30.5	8.8	1.0	7-847-5370	

Unless otherwise stated, all dimensions are in millimeters.

Pre-insulated terminals for thin insulating conductors according to EN 50306

Standards:

NFF 00363

- Material: tin-plated copper.
- Insulation according to EN 45545.
- SNCF drawing: 10-5297-405.

For packaging by 100, add C100- before the reference.

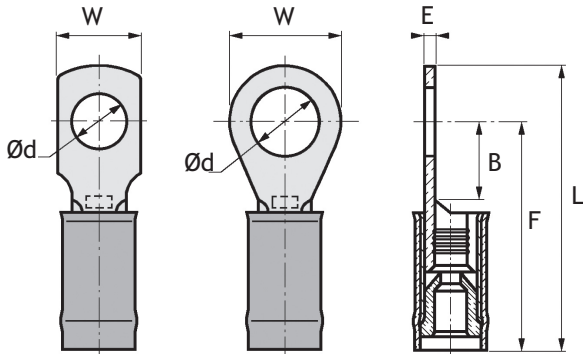

Cross section (mm ²)	Ref.	max. wire Ø	Insulation Ø		Ø d	W	E	L	F	Reducer colour	Crimping tool
			mini	maxi							
0.5	451143	1.04	1.15	2	3.2	5.6	0.8	17.3	14.5	Yellow	TH1 or THIS
	451153				3.2	8	0.8	21.5	17.5		
	451153R				3.2	6.5	0.8	21	17		
	451154				4.2	8	0.8	21.5	17.5		
	451154R				4.2	6.5	0.8	21	17		
	451155				5.2	8	0.8	21.5	17.5		
	451134				4.2	12.5	0.8	27	20.7		
	451135				5.2	12.5	0.8	27	20.7		
	451136				6.3	12.5	0.8	27	20.7		
	451138				8.4	12.5	0.8	27	20.7		
0.75	551143	1.15	1.30	2	3.2	5.6	0.8	17.3	14.5	Brown	TH1 or THIS
	551153				3.2	8	0.8	21.5	17.5		
	551153R				3.2	6.5	0.8	21	17		
	551154				4.2	8	0.8	21.5	17.5		
	551154R				4.2	6.5	0.8	21	17		
	551155				5.2	8	0.8	21.5	17.5		
	551134				4.2	12.5	0.8	27	20.7		
	551135				5.2	12.5	0.8	27	20.7		
	551136				6.3	12.5	0.8	27	20.7		
	551138				8.4	12.5	0.8	27	20.7		
1	351143	1.30	1.45	2	3.2	5.6	0.8	17.3	14.5	White	TH1 or THIS
	351153				3.2	8	0.8	21.5	17.5		
	351153R				3.2	6.5	0.8	21	17		
	351154				4.2	8	0.8	21.5	17.5		
	351154R				4.2	6.5	0.8	21	17		
	351155				5.2	8	0.8	21.5	17.5		
	351134				4.2	12.5	0.8	27	20.7		
	351135				5.2	12.5	0.8	27	20.7		
	351136				6.3	12.5	0.8	27	20.7		
	351138				8.4	12.5	0.8	27	20.7		

Note: part number with "R" suffix are square terminals.

Unless otherwise stated, all dimensions are in millimeters.

Pre-insulated terminals for thin insulating conductors according to EN 50306

- Material: tin-plated copper.
- Insulation according to EN 45545.
- SNCF drawing: 10-5297-405.

For packaging by 100, add C100- before the reference.

Standards:

NFF 00363

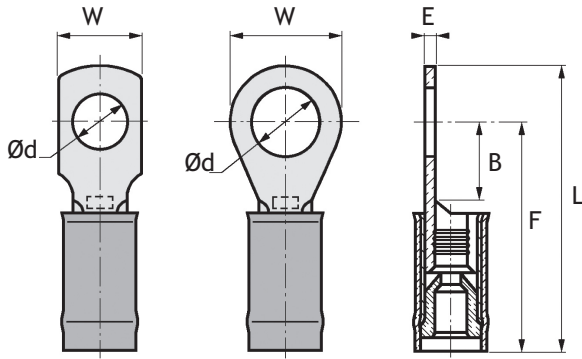

Cross section (mm ²)	Ref.	max. wire Ø	Insulation Ø		Ø d	W	E	L	F	B	Reducer colour	Crimping tool
			mini	maxi								
1.5	451183	1.65	1.80	2.70	3.2	8.6	0.8	21.5	17.2	6	Orange	TH2 or TH2S
	451183R				3.2	6.5	0.8	21	17	5.5		
	451184				4.2	8.6	0.8	21.5	17.2	6		
	451184R				4.2	6.5	0.8	21	17	5.5		
	451185				5.2	8.6	0.8	21.5	17.2	6		
	451174				4.2	12.5	0.8	27	20.7	6		
	451175				5.2	12.5	0.8	27	20.7	6		
	451176				6.3	12.5	0.8	27	20.7	6		
	451178				8.4	12.5	0.8	27	20.7	6		
2.5	551183	2.15	2.30	2.90	3.2	8.6	0.8	21.5	17.2	6	Black	TH2 or TH2S
	551183R				3.2	6.5	0.8	21	17	5.5		
	551184				4.2	8.6	0.8	21.5	17.2	6		
	551184R				4.2	6.5	0.8	21	17	5.5		
	551185				5.2	8.6	0.8	21.5	17.2	6		
	551174				4.2	12.5	0.8	27	20.7	6		
	551175				5.2	12.5	0.8	27	20.7	6		
	551176				6.3	12.5	0.8	27	20.7	6		
	551178				8.4	12.5	0.8	27	20.7	6		

Note : part number with "R" suffix are square terminals.

Unless otherwise stated, all dimensions are in millimeters.

Pre-insulated disconnects and pins terminals for thin insulating conductors according to EN 50306

Standards:

NFF 00363

Pre-insulated disconnects : tin-plated phosphorous bronze

- Insulation according to EN 45545.
- SNCF drawing: 10-5050-310.

Pre-insulated pins terminals ; tinned-plated copper

- Insulation according to EN 45545.
- SNCF drawing: 10-5297-407.

For packaging by 100, add C100- before the reference.

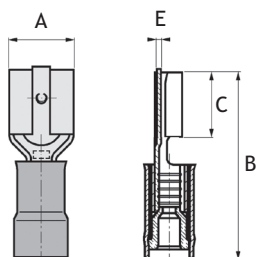

Pre-insulated disconnects for thin insulating conductors according to EN 50306

Cross section (mm ²)	Ref.	For tabs (l x e)	max. wire Ø	Insulation Ø		A	B	C	E	Reducer colour	Crimping tool
				mini	maxi						
0.5	● 451031	2.8 x 0.5	1.04	1.15	2	3.7	18.5	6.5	0.25	Yellow	TH1 or TH1S
	● 451081	5 x 0.8				6.4	21.5	7.7	0.5		
	● 451181	6.35 x 0.8				7.7	21.5	7.7	0.5		
0.75	● 551031	2.8 x 0.5	1.15	1.30	2	3.7	18.5	6.5	0.25	Brown	TH1 or TH1S
	● 551081	5 x 0.8				6.4	21.5	7.7	0.5		
	● 551181	6.35 x 0.8				7.7	21.5	7.7	0.5		
1	● 51033	2.8 x 0.5	1.30	1.45	2	3.7	18.5	6.5	0.25	White	TH1 or TH1S
	● 51083	5 x 0.8				6.4	21.5	7.7	0.5		
	● 51183	6.35 x 0.8				7.7	21.5	7.7	0.5		
1.5	● 451131	5 x 0.8	1.80	1.80	2.70	6.4	21.5	7.7	0.5	Orange	TH2 or TH2S
	● 451231	6.35 x 0.8				7.7	21.5	7.7	0.5		
2.5	● 551131	5 x 0.8	2.15	2.30	2.90	6.4	21.5	7.7	0.5	Black	TH2 or TH2S
	● 551231	6.35 x 0.8				7.7	21.5	7.7	0.5		

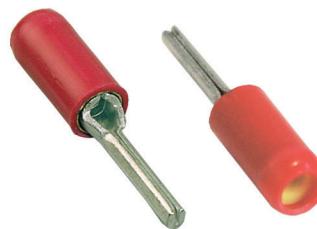
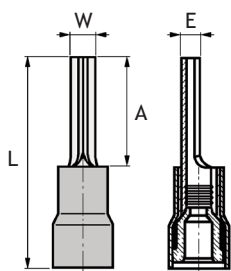

Pre-insulated pins terminals for thin insulating conductors according to EN 50306

Cross section (mm ²)	Ref.	max. wire Ø	Insulation Ø		A	B	C	E	Reducer colour	Crimping tool
			mini	maxi						
0.5	● 451220	1.04	1.15	2.0	1.6	12	22.5	1.9	Yellow	TH1 or TH1S
0.75	● 551220	1.15	1.30	2.0	1.6	12	22.5	1.9	Brown	
1	● 351220	1.30	1.45	2.0	1.6	12	22.5	1.9	White	

Unless otherwise stated, all dimensions are in millimeters.

Pre-insulated terminals for thin insulating conductors according to NFF 63808

Material: tin-plated copper.
 Insulation according to EN 45545.
 SNCF drawing: 10-5091-965.
 RATP drawing: MR-3-53173.

Standards:

NFF 00363

For packaging by 100, add C100- before the reference.

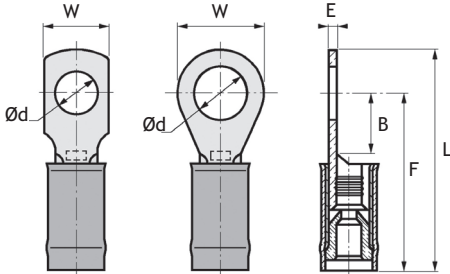

Cross section (mm ²)	Ref.	Pckg	max. wire Ø	Insulation Ø		Ø d	W	E	L	F	B	Reducer colour	SNCF code	Crimping tool
				mini	maxi									
0.6	251153	1000	1.04	1.2	2	3.2	8	0.8	21.5	17.5	6	■		TH1 or TH1S
	251153R					3.2	6.5	0.8	21	17	5.5			
	251154					4.2	8	0.8	21.5	17.5	6			
	251154R					4.2	6.5	0.8	21	17	5.5			
	251155					5.2	8	0.8	21.5	17.5	6			
	251134					4.2	12.5	0.8	27	20.7	6.5			
	251135					5.2	12.5	0.8	27	20.7	6.5			
	251136					6.3	12.5	0.8	27	20.7	6.5			
0.93	251138	1000	1.3	1.4	2	8.4	12.5	0.8	27	20.7	6.5	□	7-847-1234	TH1 or TH1S
	351153					3.2	8	0.8	21.5	17.5	6			
	351153R					3.2	6.5	0.8	21	17	5.5			
	351154					4.2	8	0.8	21.5	17.5	6			
	351154R					4.2	6.5	0.8	21	17	5.5			
	351155					5.2	8	0.8	21.5	17.5	6			
	351134					4.2	12.5	0.8	27	20.7	6.5			
	351135					5.2	12.5	0.8	27	20.7	6.5			
1.34	251178	1000	1.5	1.6	2.6	8.4	12.5	0.8	27	20.7	6	■		TH2 or TH2S
	251183					3.2	8.6	0.8	21.5	17.2	6			
	251183R					3.2	6.5	0.8	21	17	5.5			
	251184					4.2	8.6	0.8	21.5	17.2	6			
	251184R					4.2	6.5	0.8	21	17	5.5			
	251185					5.2	8.6	0.8	21.5	17.2	6			
	251174					4.2	12.5	0.8	27	20.7	6			
	251175					5.2	12.5	0.8	27	20.7	6			
1.82	251176	1000	1.73	1.73	1.9	6.3	12.5	0.8	27	20.7	6	■	7-847-7038	TH2 or TH2S
	351183					3.2	8.6	0.8	21.5	17.2	6			
	351183R					3.2	6.5	0.8	21	17	5.5			
	351184					4.2	8.6	0.8	21.5	17.2	6			
	351184R					4.2	6.5	0.8	21	17	5.5			
	351185					5.2	8.6	0.8	21.5	17.2	6			
	351174					4.2	12.5	0.8	27	20.7	6			
	351175					5.2	12.5	0.8	27	20.7	6			
351176	6.3	12.5	0.8	27	20.7	6								
351178	8.4	12.5	0.8	27	20.7	6								

Note: part number with "R" suffix are square terminals.

Unless otherwise stated, all dimensions are in millimeters.

Pre-insulated disconnects 2.8 - 5 and 6.35 and pins terminals for thin insulating conductors according to NFF 63808

Standards:

NFF 00363

- Material: tin-plated phosphorous bronze.
- Insulation according to EN 45545.
- SNCF drawing: 10-5091-966.
- RATP drawing: MR-3-53172.

For packaging by 100, add C100- before the reference.

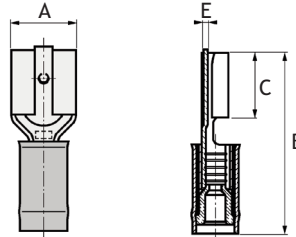

Pre-insulated disconnects for thin insulating conductors

Pre-insulated disconnects 2.8 - 5 and 6.35 for thin insulating conductors according to NFF 63808

Cross section (mm ²)	Ref.	For tabs (l x e)	max. wire Ø	Insulation Ø		A	B	C	E	Reducer colour	SNCF code	Crimping tool
				mini	maxi.							
0.6	● 51032	2.8 x 0.5	1.04	12	2	3.7	18.5	6.5	0.25	■	0-847-6041	TH1
	● 51082	5 x 0.8		12	2	6.4	21.5	7.7	0.5			TH1S
	● 51182	6.3 x 0.8		12	2	7.7	21.5	7.7	0.5			0-847-6042
0.93	● 51033	2.8 x 0.5	1.3	14	2	3.7	18.5	6.5	0.25	□	0-847-6036	TH1
	● 51083	5 x 0.8		14	2	6.4	21.5	7.7	0.5			TH1S
	● 51183	6.3 x 0.8		14	2	7.7	21.5	7.7	0.5			0-847-6038
1.34	● 51132	5 x 0.8	1.5	16	2.6	6.4	21.5	7.7	0.5	■	0-847-6043	TH2
	● 51232	6.3 x 0.8		16	2.6	7.7	21.5	7.7	0.5			TH2S
1.82	● 51133	5 x 0.8	2.6	19	2.6	6.4	21.5	7.7	0.5	■	0-847-6039	TH2
	● 51233	6.3 x 0.8		19	2.6	7.7	21.5	7.7	0.5			TH2S

- Material: tin-plated copper
- Insulation according to EN 45545
- SNCF drawing: 10-5100-991
- RATP drawing: MR-3-53170

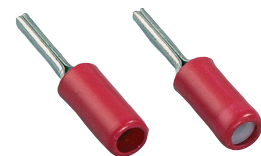
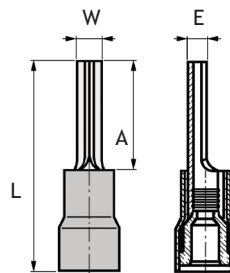
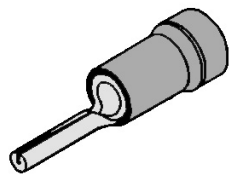

Pins terminals for thin insulating conductors

Pins terminals for thin insulating conductors according to NFF 63808

Cross section (mm ²)	Ref.	max. wire Ø	Insulation Ø		W	A	L	E	Reducer colour	Crimping tool
			mini	maxi.						
0.6	● 251220	1.04	12	2	1.6	12	22.5	1.9	■	TH1 or TH1S
0.93	● 351220	1.3	14	2	1.6	12	22.5	1.9	□	

Unless otherwise stated, all dimensions are in millimeters.

Pre-insulated butt connectors with inspection window

- Material: tin-plated copper.
- Insulation according to EN 45545.
- SNCF drawing: 10-5194-221.
- RATP drawing: MR-3-53171.

For packaging by 100, add C100- before the reference.

Standards:

NFF 00363

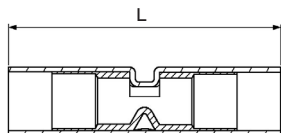

Cross section (mm ²)	Ref.	Insulation Ø	L	SNCF code	Crimping tool
0.34 - 1.5 ●	51391	3.6	32	7-847-4323	TH1 + stopper HF20 or TH1S
1 - 2.5 ●	51402	4	32	7-847-4344	TH2 + stopper HF20 or TH2S
2.6 - 6 ●	51413	5.5	41.5	7-847-4120	TH3

Unless otherwise stated, all dimensions are in millimeters

Low power pre-insulated copper tubular lugs

- Material: tin-plated copper.
- Insulation according to EN 45545.
- Suitable for copper cables according NFF or EN standards.
- SNCF drawing: 10-5102-962.
- RATP drawing: MR-3-52970.

For packaging by 100, add C100- before the reference.

Standards:

NFF 00363

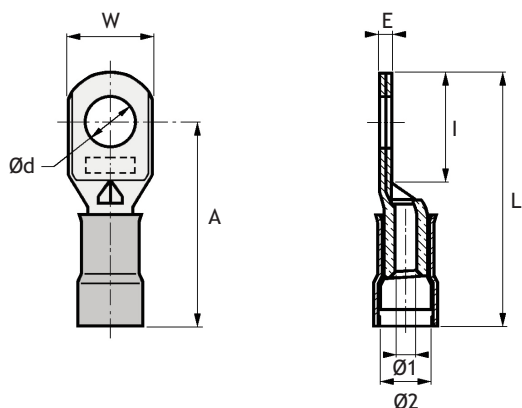

51190+ series

Cross section (mm ²)	Ref.	W	L	E	Ø d	A	I	Ø 1	Ø 2	SNCF code	Crimping tool
	51193-4BC	11	32	1.6	3.2	25.8	13.6			7-847-7033	
	51193R4BC	8.5	32	2.2	3.2	25.8	13.6			7-847-4628	
	51193RR4BC	8.5	29	2.2	3.2	23.5	10				
	511944BC	11	32	1.6	4.2	25.8	13.6			7-847-7031	
	51194R4BC	8.5	32	2.2	4.2	25.8	13.6			7-847-5040	
	51194RR4BC	8.5	29	2.2	4.2	23.5	10				
1 - 2.5 ○	51195-4BC	11	32	1.6	5.2	25.8	13.6	2.8	6.8	7-847-4837	TH3
	51195R4BC	8.5	32	2.2	5.2	25.8	13.6			7-847-4540	
	51195RR4BC	8.5	29	2.2	5.2	23.5	10				
	51196-4BC	11	32	1.6	6.4	25.8	13.6			7-847-7032	
	51198-4BC	12.5	32	1.5	8.4	25.8	14			7-847-5605	
	51193RRS4BC	7.5	32	2.2	3.2	27.8	13.5				
	51194RRS4BC	7.5	32	2.2	4.2	27.8	13.5				
	51193-2NR	11	34	1.6	3.2	27.8	13.6				
	51193R2NR	8.5	34	2.2	3.2	27.8	13.6			7-847-5366	
	51193RR2NR	8.5	31	2.2	3.2	25.5	10				
	51194-2NR	11	34	1.6	4.2	27.8	13.6				
	51194R2NR	8.5	34	2.2	4.2	27.8	13.6			7-847-5365	
1 - 2.5 ●	51194RR2NR	8.5	31	2.2	4.2	25.5	10	2.8	8.8		TH3-2
	51195-2NR	11	34	1.6	5.2	27.8	13.6			7-847-7034	
	51195R2NR	8.5	34	2.2	5.2	27.8	13.6			7-847-5363	
	51195RR2NR	8.5	31	2.2	5.2	25.5	10				
	51196-2NR	11	34	1.6	6.4	27.8	13.6			7-847-5362	
	51198-2NR	12.5	34	1.0	8.4	27.8	14			7-847-5364	

Unless otherwise stated, all dimensions are in millimeters.

Low power pre-insulated copper tubular lugs

- Material: tin-plated copper.
- Insulation according to EN 45545.
- Suitable for copper cables according NFF or EN standards.
- SNCF drawing: 10-5102-963.
- RATP drawing: MR-3-52969.

For packaging by 100, add C100- before the reference.

Standards:

NFF 00363

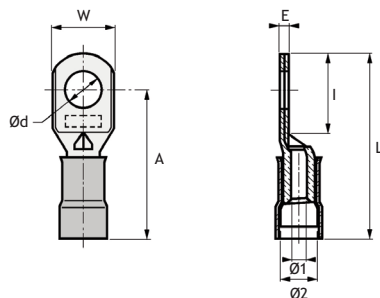

C3P+ series

Cross section (mm²)	Ref.	W	L	E	Ø d	A	I	Ø 1	Ø 2	SNCF code	Crimping tool
	C3P40-4J	11	32	1.2	4.2	25.8	13.6			7-847-4955	
	C3P40R4J	8.5	32	1.5	4.2	25.8	13.6				
	C3P40RR4J	8.5	28	1.5	4.2	24	10				
	C3P40RRS4J	7.5	32	1.9	4.2	27.8	14				
2.6 - 6	C3P50-4J	11	32	1.2	5.2	25.8	13.6	3.5	6.8	7-847-4956	TH3
	C3P50R4J	8.5	32	1.5	5.2	25.8	13.6				
	C3P50RR4J	8.5	28	1.5	5.2	22.8	10				
	C3P60-4J	11	32	1.2	6.4	25.8	13.6			7-847-4957	
	C3P80-4J	12.5	32	1.2	8.4	25.8	13.6				
	C3P40-2JN	11	34	1.2	4.2	27.8	13.6			7-847-5485	
	C3P40R2JN	8.5	34	1.5	4.2	27.8	13.6				
	C3P40RR2JN	8.5	28	1.5	4.2	24	10				
2.6 - 6	C3P50-2JN	11	34	1.2	5.2	27.8	13.6	3.5	8.8	7-847-5486	TH3-2
	C3P50R2JN	8.5	34	1.5	5.2	27.8	13.6				
	C3P50RR2JN	8.5	28	1.5	5.2	22.8	10				
	C3P60-2JN	11	34	1.2	6.4	27.8	13.6			7-847-5487	
	C3P80-2JN	12.5	34	1.2	8.4	27.8	13.6				

Unless otherwise stated, all dimensions are in millimeters.

Medium power pre-insulated copper tubular lugs

- Material: tin-plated copper.
- Insulation according to EN 45545.
- Suitable for copper cables according NFF or EN standards.
- SNCF drawing: 10-5050-317.
- RATP drawing: MR-3-52971.

Standards:

NFF 00363

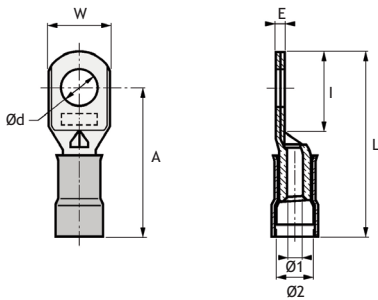

ELP series

FLP series

NP series

Cross section (mm ²)	Ref.	W	L	E	Ø d	A	I	Ø 1	Ø 2	SNCF code
10	● ELP40	14	42	2.5	4.2	34	17	5	11.2	7-847-5044
	ELP50	14	42	2.5	5.2	34	17	5	11.2	7-847-4963
	ELP60	14	42	2.5	6.3	34	17	5	11.2	7-847-4964
	ELP80	14	42	2.5	8.3	34	17	5	11.2	7-847-4965
	● ELP100	16.5	44	2.0	10.3	36	20	5	11.2	7-847-4966
	ELP120	16.5	44	2.0	12.8	36	20	5	11.2	
	ELPU40	10	42	3.3	4.2	32	17	5	11.2	
	ELPU50	10	42	3.3	5.2	32	17	5	11.2	
	ESPU50	13	42	2.3	5.2	34	17	5	11.2	
	16	● FLP50	15	46	2.5	5.2	38	20	6	13
FLP60		15	46	2.5	6.3	38	20	6	13	7-847-4969
FLP80		15	46	2.5	8.3	38	20	6	13	7-847-4970
● FLP100		18	46	2	10.3	38	21	6	13	7-847-4971
FLP120		18	46	2	12.6	38	21	6	13	
FLPU50		12.5	46	3.0	5.2	38	20	6	13	
25	● NP50	15	53	2.5	5.2	43	23	7.7	13.8	7-847-5491
	NP60	15	53	2.5	6.3	43	23	7.7	13.8	7-847-4974
	● NP80	15	53	2.5	8.3	43	23	7.7	13.8	7-847-4975
	NP100	17.5	53	2.2	10.3	43	23	7.7	13.8	7-847-5589
	NP120	17.5	53	2.2	12.8	43	23	7.7	13.8	7-847-7034

Unless otherwise stated, all dimensions are in millimeters.

Copper tubular lugs

- Material: tin-plated copper.
- Suitable for copper cables according NFF and EN standard.
- For bent terminals. specify α or α' (α max. 90° - α' maxi 45°).
- SNCF drawing: 10-5050-311.
- RATP drawing: MR-3-52966.

Standards:

- NFF 00363
- BS 4579 pt2
- RSE/STD/024/pt7
- IEC61238-1-3

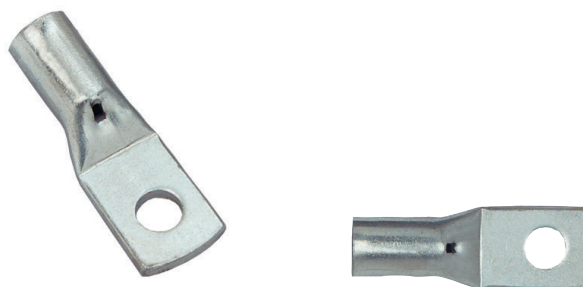
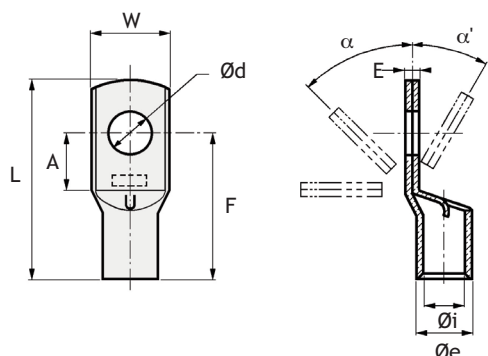

ELS, FLS and C3P...NUE series

Cross section (mm ²)	Ref.	Pckg.	W	L	E	Ø d	A	F	Ø i	Ø e	SNCF code
2.5 à 6	C100C3P40NUE	100	10.8	26	1.35	4.2	7.4	19.8	3.5	5.5	
	C100C3P50NUE	100	10.8	26	1.35	5.2	7.4	19.8	3.5	5.5	
	C100C3P60NUE	100	10.8	26	1.35	6.4	7.4	19.8	3.5	5.5	
	C100C3P80NUE	100	11.8	26	1.3	8.4	8.8	19.8	3.5	5.5	
10	ELS40	1000	14	34	2.5	4.2	9	26	5	8	7-847-7211
	ELS50	1000	14	34	2.5	5.2	9	26	5	8	7-847-7212
	ELS60	1000	14	34	2.5	6.4	9	26	5	8	7-847-7213
	ELS80	1000	14	34	2.5	8.3	9	26	5	8	7-847-7214
	ELS100	1000	16.5	36	2	10.3	12	28	5	8	7-847-7215
	ELS120	1000	16.5	36	2	12.8	12	28	5	8	7-847-7216
	ELSU40	1000	10	34	3.3	4.2	12	25	5	8	
	ELSU50	1000	10	34	3.3	4.2	12	25	5	8	
16	FLS50	500	15	37	2.5	5.2	12	29	6	9	
	FLS60	500	15	37	2.5	6.4	12	29	6	9	7-847-7217
	FLS80	500	15	37	2.5	8.3	12	29	6	9	7-847-7218
	FLS100	500	17	38	2	10.3	13	30	6	9	7-847-7219
	FLS120	500	17	38	2	12.8	13	30	6	9	7-847-7220
	FLSU50	500	12.5	37	3	5.2	13	29	6	9	7-847-5486

Unless otherwise stated, all dimensions are in millimeters.

Copper tubular lugs

- Material: tin-plated copper or nickel plated
- Suitable for copper cables according NFF and EN standard
- For bent terminals, specify α or α' (α max. 90° - α' maxi 45°)
- For the number of crimps, refer to the table on page 75.
- SNCF drawing: 10-5050-311
- RATP drawing: MR-3-52966

Standards:

NFF 00363
BS 4579 pt2
RSE/STD/024/pt7
IEC61238-1-3

Crimping from 25 up to 185 mm²

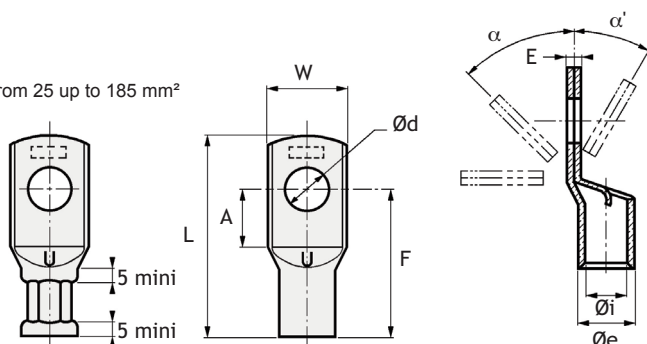

TN series

Cross section (mm ²)	Ref.	Pckg.	W	L	E	Ø d	A	F	Ø i	Ø e	SNCF code
25	TN25-5	500	15	45	2.5	5.2	13	35	7.7	10.5	7-847-5853
	TN25-6	500	15	45	2.5	6.4	13	35	7.7	10.5	7-847-5854
	TN25-8	500	15	45	2.5	8.3	13	35	7.7	10.5	7-847-5855
	TN25-10	250	17.5	45	2.2	10.3	13	35	7.7	10.5	7-847-4147
	TN25-14	200	21.5	53.5	2	14.5	14.5	39	7.7	10.5	
35	TN35-6	250	18	50	3.0	6.4	13	39	9.0	12	7-847-7222
	TN35-8	250	18	50	3.0	8.3	13	39	9.0	12	7-847-7223
	TN35-10	250	18	50	3.0	10.3	13	39	9.0	12	7-847-7224
50	TN50-6	200	21	58	3.0	6.4	14	46	10.8	14	7-847-5860
	TN50-8	200	21	58	3.0	8.3	14	46	10.8	14	7-847-5861
	TN50-10	200	21	58	3.0	10.3	14	46	10.8	14	7-847-5862
	TN50-12	100	21	58	3.0	12.8	14	46	10.8	14	7-847-5863
	TN50-14	200	21	58	3.0	14.5	14	46	10.8	14	
60	TN60-6	100	22	60	3.2	6.4	14	42	11.8	15	
	TN60-8	100	22	60	3.2	8.3	14	42	11.8	15	
	TN60-10	100	22	60	3.2	10.3	14	42	11.8	15	
	TN60-12	100	22	60	3.2	12.8	14	42	11.8	15	
70	TN70-6	100	23	66	3.5	6.4	17	51	12.5	16	
	TN70-8	100	23	66	3.5	8.3	17	51	12.5	16	7-847-5864
	TN70-10	100	23	66	3.5	10.3	17	51	12.5	16	7-847-5865
	TN70-12	100	23	66	3.5	12.8	17	51	12.5	16	7-847-5866
	TN70-14	200	23	66	3.5	14.5	17	51	12.5	16	
	TN70-16	200	23	66	3.5	16	17	51	12.5	16	
95	TN95-6	100	27	73	4.0	10.3	18	56.5	14.5	18.5	
	TN95-8	100	27	73	4.0	12.8	18	56.5	14.5	18.5	
	TN95-10	100	27	73	4.0	10.3	18	56.5	14.5	18.5	7-847-5868
	TN95-12	100	27	73	4.0	12.8	18	56.5	14.5	18.5	7-847-5869
	TN95-14	100	27	73	4.0	14.5	18	56.5	14.5	18.5	7-847-5870
	TN95-16	100	27	73	4.0	12.8	18	56.5	14.5	18.5	

Unless otherwise stated, all dimensions are in millimeters.

Copper tubular lugs

- Material: tin-plated copper or nickel plated
- Suitable for copper cables according NFF and EN standard
- For bent terminals, specify α or α' (α max. 90° - α' maxi 45°)
- For the number of crimps, refer to the table on page 75.
- SNCF drawing: 10-5050-311
- RATP drawing: MR-3-52966.

Standards:

- NFF 00363
- BS 4579 pt2
- RSE/STD/024/pt7
- IEC61238-1-3

Crimping from 25 up to 185 mm²

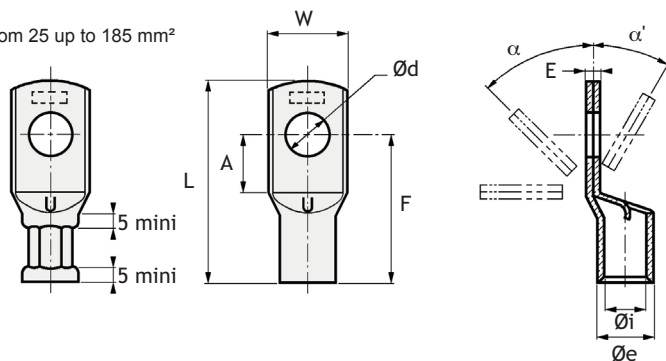

TN series

Cross section (mm ²)	Ref.	Pckg.	W	L	E	Ø d	A	F	Ø i	Ø e	SNCF code
120	TN120-8	50	30	83.5	4.5	8.3	21	65.5	16.5	21	
	TN120-10	50	30	83.5	4.5	10.3	21	66	16.5	21	
	TN120-12	50	30	83.5	4.5	12.8	21	66	16.5	21	7-847-5871
	TN120-14	50	30	83.5	4.5	14.5	21	66	16.5	21	7-847-5872
	TN120-16	50	30	83.5	4.5	16.5	21	66	16.5	21	7-847-5873
150	TN150-8	50	32	90	4.5	8.3	23	71	18	23	
	TN150-10	50	32	90	4.5	10.3	23	71	18	23	
	TN150-12	50	32	90	4.5	12.8	23	71	18	23	7-847-5620
	TN150-14	50	32	90	4.5	14.5	23	71	18	23	7-847-5874
	TN150-16	50	32	90	4.5	16.5	23	71	18	23	7-847-5875
	TN150-18	50	32	90	4.5	18.8	23	71	18	23	7-847-5876
185	TN185-10	25	38	102	5.5	10.3	23	78	20.5	26	
	TN185-12	25	38	102	5.5	12.8	23	78	20.5	26	7-847-5877
	TN185-14	25	38	102	5.5	14.5	23	78	20.5	26	7-847-5878
	TN185-16	25	38	102	5.5	16.5	23	78	20.5	26	7-847-5879
	TN185-18	25	38	102	5.5	18.8	23	78	20.5	26	7-847-5880
240	TN240-10	25	42	110	6	10.3	28	86	23	29	
	TN240-12	25	42	110	6	12.8	28	86	23	29	
	TN240-14	25	42	110	6	14.5	28	86	23	29	7-847-5881
	TN240-16	25	42	110	6	16.5	28	86	23	29	7-847-5882
	TN240-18	25	42	110	6	18.8	28	86	23	29	7-847-5883
	TN240-20	25	42	110	6	21	28	86	23	29	
300	TN300-16	25	48	123	7	16.5	32	97	26	33	7-847-4146
	TN300-18	25	48	123	7	18.8	32	97	26	33	7-847-5884
	TN300-20	25	48	123	7	21	32	97	26	33	
	TN300-22	25	48	123	7	22.9	32	97	26	33	7-847-5885

Unless otherwise stated, all dimensions are in millimeters.

Copper tubular lugs

- Material: tin-plated copper.
- Suitable for copper cables according NFF and EN standard.
- For bent terminals, specify α or α' (α max. 90° - α' maxi 45°).
- For the number of crimps, refer to the table on page 75.
- SNCF drawing: 10-5050-312.
- RATP drawing: MR-3-52966.

Standards:

NFF 00363
BS 4579 pt2
RSE/STD/024/pt7

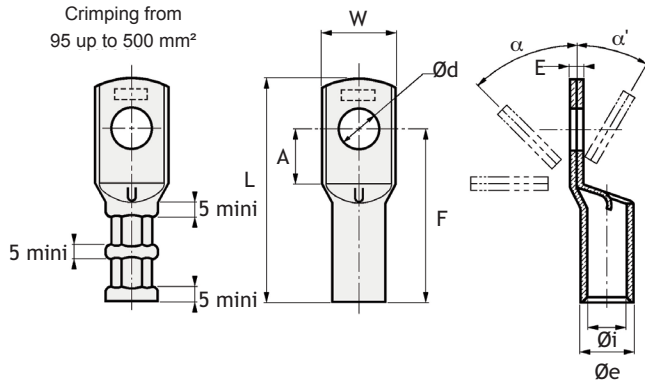

TR series

Cross section (mm ²)	Ref.	Pckg.	W	L	E	Ø d	A	F	Ø i	Ø e
95	TR95-10	50	30.5	80	6	10.3	18.3	64	15.5	21.5
	TR95-12	50	30.5	80	6	12.8	18.3	64	15.5	21.5
	TR95-14	50	30.5	80	6	14.5	18.3	64	15.5	21.5
	TR95-16	50	30.5	80	6	16.5	18.3	64	15.5	21.5
	TR95-18	50	30.5	80	6	18.8	18.3	64	15.5	21.5
120	TR120-10	25	34	88.5	6.6	10.3	24	70.5	17.6	24.5
	TR120-12	25	34	88.5	6.6	12.8	24	70.5	17.6	24.5
	TR120-14	25	34	88.5	6.6	14.5	24	70.5	17.6	24.5
	TR120-16	25	34	88.5	6.6	16.5	24	70.5	17.6	24.5
	TR120-18	25	34	88.5	6.6	18.8	24	70.5	17.6	24.5
150	TR150-10	25	37	96	7	10.3	21	75	19	26
	TR150-12	25	37	96	7	12.8	21	75	19	26
	TR150-14	25	37	96	7	14.5	21	75	19	26
	TR150-16	25	37	96	7	16.5	21	75	19	26
	TR150-18	25	37	96	7	18.8	21	75	19	26
	TR150-20	25	37	96	7	21	21	75	19	26
185	TR185-12	20	40	104.5	7	12.8	27	82.5	21	28
	TR185-14	20	40	104.5	7	14.5	27	82.5	21	28
	TR185-16	20	40	104.5	7	16.5	27	82.5	21	28
	TR185-18	20	40	104.5	7	18.8	27	82.5	21	28
	TR185-20	20	40	104.5	7	21	27	82.5	21	28
	TR185-22	20	40	104.5	7	22.9	27	82.5	21	28
240	TR240-16	20	44	112	7	16.5	27	88	24	31
	TR240-18	20	44	112	7	18.8	27	88	24	31
	TR240-20	20	44	112	7	21	27	88	24	31
	TR240-22	20	44	112	7	22.9	27	88	24	31
300	TR300-16	10	50	130	8.5	16.5	28	103	26.5	35
	TR300-18	10	50	130	8.5	18.8	28	103	26.5	35
	TR300-20	10	50	130	8.5	21	28	103	26.5	35
	TR300-22	10	50	130	8.5	22.9	28	103	26.5	35
	TR300-24	10	50	130	8.5	25	28	103	26.5	35
400	TR400-24	10	60.5	130	9	24.9	28	100	33	42
500	TR500-30	10	72	140	10	30.9	32	110	40	50

Unless otherwise stated, all dimensions are in millimeters.

Two hole copper tubular lugs

- Material: tin-plated copper.
- Suitable for copper cables according NFF and EN standard.
- For bent terminals, specify α or α' (α max. 90° - α' max 45°).
- For the number of crimps, please refer to the table on page 75.
- SNCF drawing: 10-5050-312.
- RATP drawing: MR-3-52966.

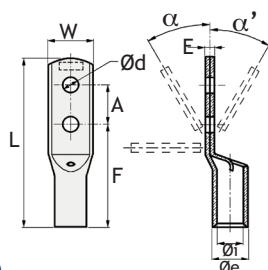

Standards:

NFF 00363

Two hole and narrow palm terminale

TRS series

Cross section (mm ²)	Ref.	Pckg.	W	L	E	Ø d	A	F	Ø i	Ø e
150	TRS150-12	25	34	135	4.5	12.8	40		17.5	22.9
185	TRS185	25	34.5	151	7	12.8	40	90	21.8	28.5
240	TRS240	20	34.5	150	7	12.8	40	90	24	30.6
400	TRS400	10	49.5	180	9	14.8	50	105	26.5	35

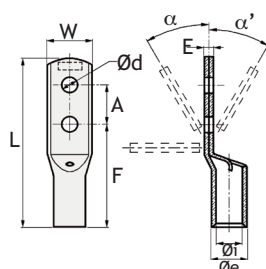

Two hole foolproofing lugs for motor terminal box

TN series

Cross section (mm ²)	Ref.	Pckg.	W	L	E	Ø d	A	F	Ø i	Ø e
50	TN50-10-24	50	20	86	3	10.3	24	47	10.8	14
	TN50-10-29	50	20	91	3	10.3	29	47	10.8	14
	TN50-10-34	50	20	96	3	10.3	34	47	10.8	14
70	TN70-10-24	50	23	87	3.5	10.3	24	51	12.5	16
	TN70-10-29	50	23	94	3.5	10.3	29	51	12.5	16
	TN70-10-34	50	23	99	3.5	10.3	34	51	12.5	16
95	TN95-10-24	50	27.5	93	4	10.3	24	56.5	14.5	18.5
	TN95-10-29	50	27.5	98	4	10.3	29	56.5	14.5	18.5
	TN95-10-34	50	27.5	103	4	10.3	34	56.5	14.5	18.5
120	TN120-10-24	50	30	105	4.5	10.3	24	68	16.5	21
	TN120-10-29	50	30	105	4.5	10.3	29	63	16.5	21
	TN120-10-34	50	30	105	4.5	10.3	34	58	16.5	21

Two hole terminals - NEMA space (25.4 mm)

Cross section (mm ²)	Ref.	Pckg.	W	L	E	Ø d	A	F	Ø i	Ø e
70	TN70-10-25.4	50	23	87	3.5	10.3	25.4	49.5	12.5	16
95	TN95-10-25.4	50	26.5	94	4	10.3	25.4	53.5	14.5	18.5
120	TN120-10-25.4	50	30	102	4.5	10.3	25.4	61.5	16.5	21
150	TN150-10-25.4	50	33	109	5	10.3	25.4	67.5	18	23
240	TN240-10-25.4	20	42	113.5	6	10.3	25.4	73	23	29

Unless otherwise stated, all dimensions are in millimeters.

Copper tubular lugs with axial and narrow palm, especially suitable to go through cable glands

Standards:

NFF 00363

- Material: tin-plated copper.
- SNCF drawing: 10-5050-313.
- RATP drawing: MR-3-52968.
- Note: two hexagonal crimping from 185 mm².

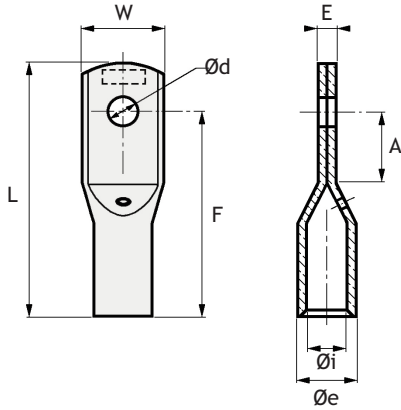

TRS series

Cross section (mm ²)	Ref.	Pckg.	W	L	E	$\varnothing d$	A	F	$\varnothing i$	$\varnothing e$	SNCF code	Comments
95	TRS95-10	50	24	82	6	10.3	30	67	15.5	21.5		Narrow palm
	TRS95-12	50	24	82	6	12.8	30	67	15.5	21.5		
120	TRS446-10	50	23	73	6	10.3	18	56	16.5	22.5		Narrow palm
	TRS446-12	50	23	73	6	12.8	18	56	16.5	22.5	0-847-6109	
	TRS446-14	50	23	73	6	14.5	18	56	16.5	22.5	0-847-6107	
	TRS448-10	50	23	86	6	10.3	28	67	16.5	22.5		
	TRS448-12	50	23	86	6	12.8	28	67	16.5	22.5		
	TRS448-14	50	23	86	6	14.5	28	67	16.5	22.5		
150	TRS450	50	30	90	6	12.8	27	71	18.5	24.5		Narrow palm
	TRS450-14	50	30	90	6	14.5	27	71	18.5	24.5		
185	TRS452-12	25	32	107	7	12.8	40	87	21	27		
	TRS452	25	32	107	7	14.5	40	87	21	27		
	TRS452-16	25	32	107	7	16.5	40	87	21	27		
	TRS452OBL	25	32	107	7	17/19	40	87	21	27		
240	TRS455	20	32	107	8	14.5	28	86	23	29		Machining lug drawing 10-5091834
	TRS455-12PE	50	29.5	107	8	12.8	28	86	23	29		Machining lug with narrow palm

Unless otherwise stated, all dimensions are in millimeters.

Copper tubular lugs for flexible copper cables with insulation crimping

- Tin plated copper.
- "B" crimp one wire.
- Hexagonal crimping for insulation.

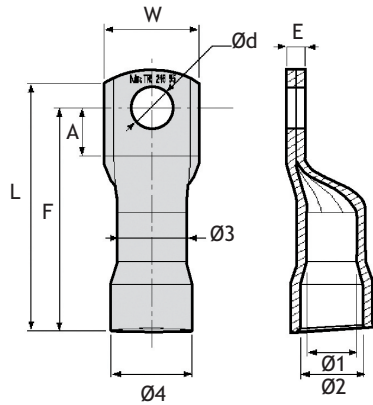

Cross section (mm ²)	Ref.	Pckg.	W	L	E	Ø d	A	F	Ø 1	Ø 2	Ø 3	Ø 4	Dies	
													Wire crimping	Insulation crimping
35	TRS243-8	50	20	71	3.8	8.3	10	61	10	13.5	14	17.5	C12TRS-243BS	C12TRS-243FH
	TRS243-10	50	20	71	3.8	10.3	10	61	10	13.5	14	17.5		C12TR-S243EXPFH
	TRS243-8EXP	50	20	70	3.8	8.3	10	60	10	14.5	14	18.5	C12TRS-244BS	C12TRS-244FH
	TRS243-10EXP	50	20	70	3.8	10.3	10	60	10	14.5	14	18.5		C12TR-S244EXPFH
50	TRS244-10	50	23	79	6	10.3	13	67	11	16	17	22	C12TRS-245BS	C12TRS-245FH
	TRS244-12	50	23	79	6	12.3	13	67	11	16	17	22		C12TR-S245EXPFH
	TRS244-10EXP	50	23	78	6	10.3	13	66	11	17	17	23	C12TRS-246BS	C12TRS-246FH
	TRS244-12EXP	50	23	78	6	12.3	13	66	11	17	17	23		C12TR-S246EXPFH
70	TRS245-10	50	26	82	4.4	10.3	13	70	13.5	17.5	18	22	C12TRS-246BS	C12TRS-246FH
	TRS245-12	50	26	82	4.4	12.8	13	70	13.5	17.5	18	22		C12TR-S246EXPFH
	TRS245-10EXP	50	26	81	4.4	10.3	13	69	13.5	18.5	18	23	C12TRS-246BS	C12TRS-246FH
	TRS245-12EXP	50	26	81	4.4	12.8	13	69	13.5	18.5	18	23		C12TR-S246EXPFH
95	TRS246-10	50	30	82	6	10.3	15	70	15.5	19.5	21.5	25.5	C12TRS-246BS	C12TRS-246FH
	TRS246	50	30	82	6	12.8	15	70	15.5	19.5	21.5	25.5		C12TR-S246EXPFH
	TRS246-10EXP	50	30	81.5	6	10.3	15	69.5	15.5	20.5	21.5	26.5	C12TRS-246BS	C12TRS-246FH
	TRS246EXP	50	30	81.5	6	12.8	15	69.5	15.5	20.5	21.5	26.5		C12TR-S246EXPFH

Unless otherwise stated, all dimensions are in millimeters.

Special copper tubular lugs

Material: tin plated copper.

Standards:

UFF 00363

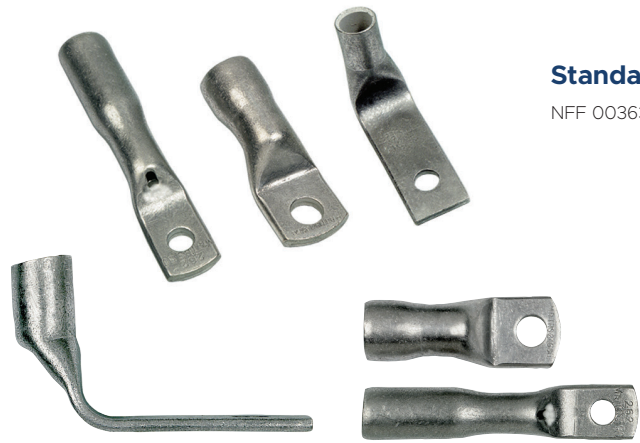
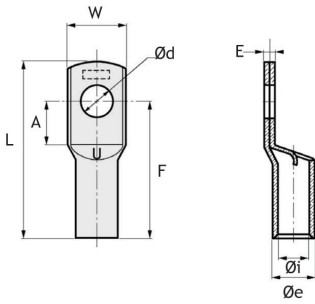

Narrow palm lugs

Cross section (mm ²)	Ref.	Pckg.	W	L	E	Ø d	A	F	Ø 1	Ø 2	Comments
185	TRS185-1B	25	34.5	111	7	12.8	20.5	92	21.8	28.5	Die TRS185, 2 crimps
240	TRS240-1B	25	34.5	110	7	12.8	21.5	90.5	24	30.6	Die TRS240, 2 crimps
	TRS242-12	25	38	110	6	12.8	28	86	23	30	Die TRS258, 2 crimps

Back traction copper lugs with insulation crimping

TRS 262: SNCF code 7-847-7035

(SNCF drawing: 10-5050-314)

RATP drawing: MR-3-53174)

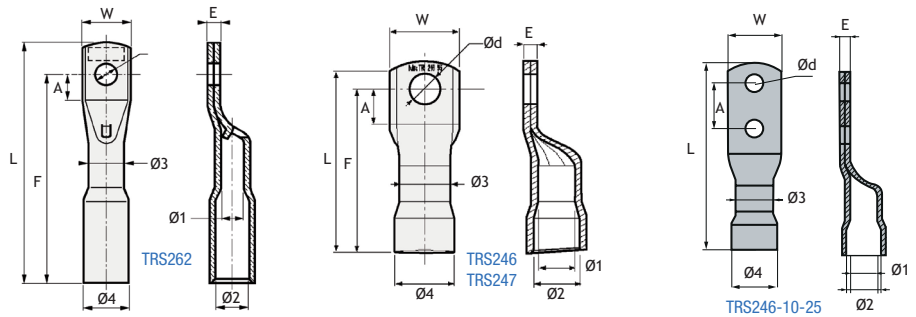

Cross section (mm ²)	Ref.	Pckg.	W	L	E	Ø d	A	F	Ø 1	Ø 2	Ø 3	Ø 4	Comments
50	TRS262	25	23.3	23.3	23.3	23.3	23.3	23.3	23.3	23.3	17	21.5	
95	TRS246	50	30	30	30	30	30	30	30	30	21.5	25.5	1 wire crimping + 1 insulation crimping
	TRS246-10-25	50	30	30	30	30	30	30	30	30	21.5	25.5	
120	TRS247	50	30	30	30	30	30	30	30	30	24.5	29.3	

Specific bent lugs

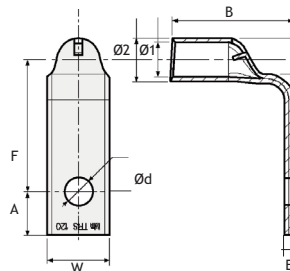

Cross section (mm ²)	Ref.	Pckg.	W	L	E	Ø d	A	F	Ø 1	Ø 2	Comments
95	TRS95-12-90E	50	26.5	44	3.6	12.8	16	76	14.5	18.5	Die TN95, 1 crimping
	TRS95-16-90E	50	18.5	44	3.6	16.5	16	76	14.5	18.5	
120	TRS120-12-90E	25	30.2	60	4.5	12.8	16	65	16.5	21	Die TN120, 1 crimping
150	TRS150-12-90E	25	33	60	5	12.8	19	65	18	23	Die TN150, 1 crimping
	TRS150-16-90E	25	33	60	5	16.5	16	65	18	23	
185	TRS185-12-90E	25	37.5	76	5.5	12.8	24	70	20.6	26	Die TN185, 1 crimping
240	TRS240-16-90E	20	42	81	6	16.5	24	75	23	29	Die TN240, 2 crimps

Unless otherwise stated, all dimensions are in millimeters.

Aluminium tubular lugs

- Material: tin plated aluminium.
- SNCF drawing: 10-5089-290.
- RATP drawing: MR-3-53175.
- Note: from 50 up to 150 mm²: two hexagonal crimping.

Standards:

NFF 00363

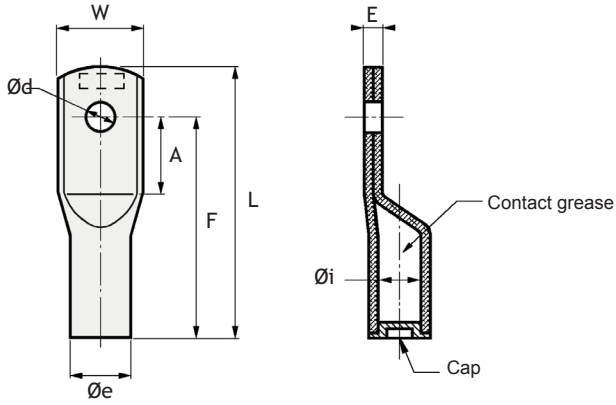

Cross section (mm ²)	Ref.	Pckg.	W	L	E	$\varnothing d$	A	F	$\varnothing i$	$\varnothing e$	SNCF code
50	AL50-6	100	20.6	65	5	6.4	17	52	10.8	15.8	
	AL50-8	100	20.6	65	5	8.3	17	52	10.8	15.8	
	AL50-10	100	20.6	65	5	10.3	17	52	10.8	15.8	
	AL50-12	100	20.6	65	5	12.8	17	52	10.8	15.8	
60	AL60-8	100	20.6	69	5	8.3	20	56	11.6	16.3	
	AL60-10	100	20.6	69	5	10.3	20	56	11.6	16.3	7-847-4595
	AL60-12	100	21.5	69	5	12.8	20	56	11.6	16.3	
70	AL70-8	100	21	82	4.6	8.3	22.5	65	12.5	17	
	AL70-10	100	21	82	4.6	10.3	22.5	65	12.5	17	
	AL70-12	100	21	82	4.6	12.8	22.5	65	12.5	17	
95	AL95-8	50	28	87	6	8.3	24.5	70.5	14	20	
	AL95-10	50	28	87	6	10.3	24.5	70.5	14	20	
	AL95-12	50	28	87	6	12.8	24.5	70.5	14	20	
	AL95-14	50	28	87	6	14.5	24.5	70.5	14	20	
120	AL120-10	50	28	87	6	10.3	24.5	70.5	16.5	22	
	AL120-12	50	28	87	6	12.8	24.5	70.5	16.5	22	
	AL120-14	50	28	87	6	14.5	24.5	70.5	16.5	22	
150	AL150-10	50	28.5	95	6	10.3	28	82	18.5	24	
	AL150-12	50	28.5	95	6	12.8	28	82	18.5	24	
	AL150-14	50	28.5	95	6	14.5	28	82	18.5	24	
	AL150-16	50	28.5	95	6	16.5	28	82	18.5	24	
	AL150 B-14	50	28.5	110	6	14.5	25.5	90	18.5	24	7-847-8251
	AL150 B-16	50	28.5	110	6	16.5	25.5	90	18.5	24	
	AL150 B-18	50	28.5	110	6	18.8	25.5	90	18.5	24	

Unless otherwise stated, all dimensions are in millimeters.

Aluminium tubular lugs

- Material: tin plated aluminium.
- SNCF drawing: 10-5089-290.
- RATP drawing: MR-3-53175.
- Note: from 185 up to 460 mm² : two hexagonal crimping.

Standards:

NFF 00363

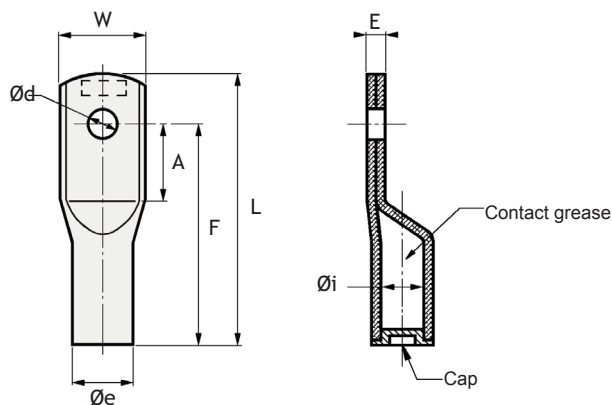

Cross section (mm ²)	Ref.	Pckg.	W	L	E	Ø d	A	F	Ø i	Ø e	SNCF code
185	AL185-10	25	34	130	6	10.3	25.5	110	21	27	
	AL185-12	25	34	130	6	12.8	25.5	110	21	27	
	AL185-14	25	34	130	6	14.5	25.5	110	21	27	
	AL185-16	25	34	130	6	16.5	25.5	110	21	27	
240	AL240-10	25	41	130	6,5	10,4	28	110	23	30	
	AL240-12	25	41	130	6,5	12,8	28	110	23	30	
	AL240-14	25	41	130	6,5	14,5	28	110	23	30	7-847-7355
	AL240-16	25	41	130	6,5	16,5	28	110	23	30	
	AL240-18	25	41	130	6,5	18,8	28	110	23	30	
	AL240-20	25	41	130	6,5	21	28	110	23	30	
260	AL260-14	20	38.5	114	6.5	14.5	29	94	25.5	32	
	AL260-16	20	38.5	114	6.5	16.5	29	94	25.5	32	
	AL260-18	20	38.5	114	6.5	18.8	29	94	25.5	32	
300	AL300-14	20	46	136	8.8	14.5	30	113	27	34.6	
	AL300-16	20	46	136	8.8	16.5	30	113	27	34.6	
	AL300-18	20	46	136	8.8	18.8	30	113	27	34.6	
	AL300-20	20	46	136	8.8	21	30	113	27	34.6	
460	AL460-16	10	52	150	10	16.5	35	125	32.5	42	
	AL460-18	10	52	150	10	18.8	35	125	32.5	42	
	AL460-20	10	52	150	10	21	35	125	32.5	42	
	AL460-22	10	52	150	10	23	35	125	32.5	42	
	AL460-24	10	52	150	10	25	35	125	32.5	42	

Unless otherwise stated, all dimensions are in millimeters.

**A range of nickel plated lugs,
TN copper series,**

**A solution for use above
110 degrees.**





03

I Railway infrastructure

Forged lugs for aluminium cables

P. 44

Forged lugs for aluminium cables

- Material: Aluminium 99.5%.
- Tin-plated : 15 µm.
- Crimping position.
- Short cut current :
 - * 75 mm² = 25 KA ms.
 - * 110 mm² = 40 KA 100 ms.
- Tightening torque tested to 80 Nm which guarantee a perfect installation same with high vibration level.



**DEUTSCHE BAHN
APPROVED**

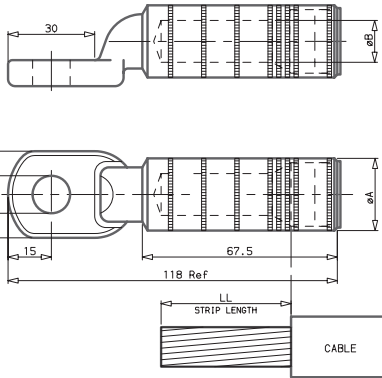

Long barrel terminal for rail connection with wire and insulation crimping

Cross section (mm ²)	Ref.	Ø K	Ø A	Ø B	Insulation Ø	Type of cables	Die
110/100	Y4CA110A22M12HTN15	13	25	14.5	22	(N)AYY-0 1x110 RM 0.6/1KV ALMG	U215BGE5T (3 crimps) with 60 KN tool
	Y4CA110A22M16HTN15	17	25	14.5	22	(N)A(ST)YY-0 1x110 RM 0.6/1KV ALMGST (N)A(ST)YY-0 1x100 RM 0.6/1KV ALMGST	
75	Y4CA075A22M12HTN15	13	25	12	20	(N)A(ST)YY-0 1x75 RM 0.6/1KV ALMGST	
	Y4CA075A22M16HTN15	17	25	12	20		

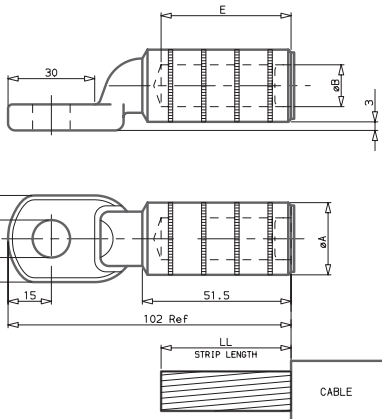

Short barrel terminal for noise protection wall grounding

Cross section (mm ²)	Ref.	Ø K	Ø A	Insulation Ø	Type of cables	Matrice
110/100	Y4CA110A22M12TN15	13	25	14.5	(N)AYY-0 1x110 RM 0.6/1KV ALMG	U215BGE5T (3 crimps) with 60 KN tool
	Y4CA110A22M16TN15	17	25	14.5	(N)A(ST)YY-0 1x110 RM 0.6/1KV ALMGST (N)A(ST)YY-0 1x100 RM 0.6/1KV ALMGST	
75	Y4CA075A22M12TN15	13	25	12	(N)A(ST)YY-0 1x75 RM 0.6/1KV ALMGST	
	Y4CA075A22M16TN15	17	25	12		

Unless otherwise stated, all dimensions are in millimeters.

04

I Signalling and stationary equipment products

Pre-insulated terminals

P. 46

Pre-insulated blade and pins

P. 48

Pre-insulated butt connectors with inspection window

P. 49

Copper tubular lugs and butt connectors

P. 50

Pre-insulated ring terminals

- Material: tin-plated copper.
- Insulation according to EN 45545.
- SNCF drawing: 10-5050-309.
- RATP drawing: MR-3-52964.

Standards:

NFF 00363

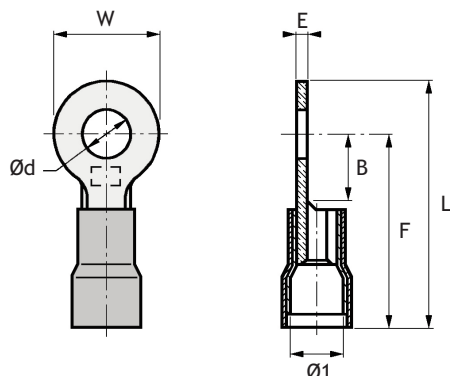

Cross section (mm ²)	Ref.	Ref. SNCF	W	L	E	Ø d	F	B	Ø 1	SNCF code	Crimping tool
0.34 - 1.5	● 51143-2	7-847-4839	5.6	17.3	0.8	3.2	14.5	3.5	3.6	0-391-6840	THIS
	● 51154-2	7-847-5028	8	21	0.8	4.2	17	6	3.6		
	● 51155-2	7-847-1112	8	21	0.8	5.2	17	6	3.6		
	● 51136-2	7-847-4251	12.5	27	0.8	6.3	20.7	6.5	3.6		
0.34 - 1.5	○ 51143-2BC	7-847-5369	5.6	17.3	0.8	3.2	14.5	3.5	3.6	0-391-6840	THIS
	○ 51154-2BC	7-847-5368	8	21	0.8	4.2	17	6	3.6		
	○ 51135-2BC	7-847-4984	12.5	27	0.8	5.2	20.7	6.5	3.6		
	○ 51136-2BC	7-847-5367	12.5	27	0.8	6.3	20.7	6.5	3.6		
1 - 2.5	● 51183-2	7-847-5237	8.6	21	0.8	3.2	16.7	6	4.8	7-847-7141	TH2S
	● 51184-2	7-847-5532	8.6	21	0.8	4.2	16.7	6	4.8		
	● 51185-2	7-847-5483	8.6	21	0.8	5.2	16.7	6	4.8		
	● 51176-2	7-847-5484	12.5	27	0.8	6.3	20.7	6	4.8		
	● 51178-2	7-847-4678	12.5	27	0.8	8.4	20.7	6	4.8		
2.6 - 6	● 51143-2JN	7-847-5389	9.6	29.5	1	4.2	24.7	7	8.8	0-391-6837	TH3-2
	● 51154-2JN	7-847-4679	9.6	29.5	1	5.2	24.7	7	8.8		
	● 51135-2JN	7-847-4216	9.6	29.5	1	6.3	24.7	7	8.8		
	● 51176-2JN	7-847-4363	13.8	35	1	8.4	28.1	8	8.8		
	● 51178-2JN	7-847-5390	13.8	35	1	10.3	28.1	8	8.8		
	● 51186-2JN	7-847-4886	19	42	1	12.8	32.5	14	8.8		

Unless otherwise stated, all dimensions are in millimeters.

Pre-insulated fork terminals

- Material: tin-plated copper.
- Insulation according to EN 45545.
- SNCF drawing: VZA 17692/000002.

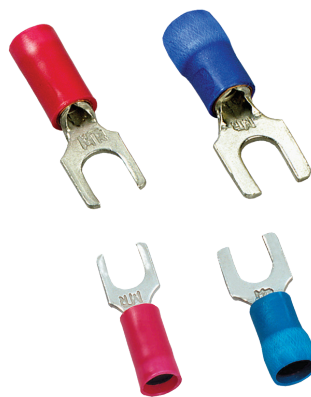
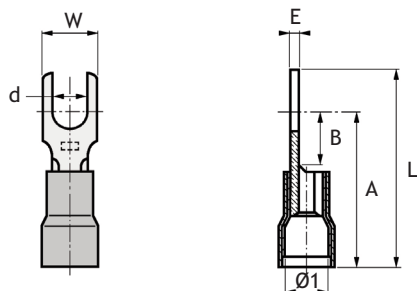

Standards:

NFF 00363

Cross section (mm ²)	Ref.	Ref. SNCF	W	L	E	Ø d	A	B	Ø 1	SNCF code	Crimping tool
0.34 - 1.5	● STRGFA1-3-2	7-847-5750	5.5	20	0.8	3.2	16.3	6	3.6	0-391-6840 TH1S	
	● STRGFA2-4-2	7-847-5006	8	20	0.8	4.2	16.4	6	3.6		
	● STRGFA2-5-2	7-847-5007	8	20	0.8	5.3	16.4	6	3.6		
0.34 - 1.5	○ STRGFA2-4-2BC	7-847-5005	8	20	0.8	4.2	16.4	6	3.6	0-391-6840 TH1S	
	● STRGFB1-3-2	7-847-4682	7.9	20.5	0.8	3.2	16.5	6	4.8		
1 - 2.5	● STRGFB1-4-2	7-847-4683	7.9	20.5	0.8	4.2	16.5	6	4.8	7-847-7141 TH2S	
	● STRGFB2-5-2	7-847-4684	9.5	23	0.8	5.3	18.8	8	4.8		
	● STRGFC1-4-2JN	7-847-5391	9.5	29	1	4.2	24.2	4.5	8.8		
2.6 - 6	● STRGFC1-5-2JN	7-847-5392	9.5	29	1	5.2	24.2	4.5	8.8	0-391-6837 TH3-2	
	● STRGFC1-6-2JN	7-847-5119	9.5	29	1	6.2	24.2	4.5	8.8		

Pre-insulated tubular lugs

- Material: tin-plated copper.
- Insulation according to EN 45545.
- SNCF drawing: VZA 17692/000008.

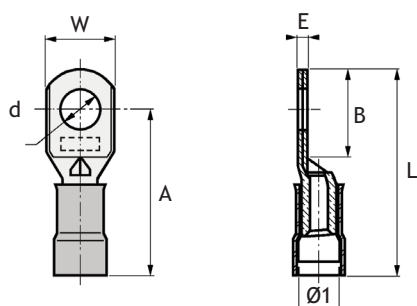

Cross section (mm ²)	Ref.	Ref. SNCF	W	L	E	Ø d	A	B	Ø 1	SNCF code	Crimping tool
1 - 3.18	● 51193R-2NR	7-847-5366	8.1	34	2.2	3.2	27.8	7.4	8.8	0-391-6837 TH3-2	
	● 51194R-2NR	7-847-5365	8.1	34	2.2	4.2	27.8	7.4	8.8		
	● 51195R-2NR	7-847-5363	8.1	34	2.2	5.2	27.8	7.4	8.8		
	● 51196-2NR	7-847-5362	10.6	34	1.6	6.4	27.8	7.4	8.8		
	● 51198-2NR	7-847-5364	11.6	34	1	8.4	27.8	7.4	8.8		
7.42	● C4P60-2G	7-847-5361	10.6	34	1.2	6.4	25.8	7.4	8.8	0-391-6837 TH3-2	
	● C4P80-2G	7-847-5661	11.6	34	1.2	8.4	22.8	7.4	8.8		

Unless otherwise stated, all dimensions are in millimeters.

Pre-insulated disconnects 2.8 - 5 - 6.35 mm

- Material: tin plated phosphorous bronze.
- Insulation according to EN 45545.
- SNCF drawing: VZA 17692/000001.

Standards:

NFF 00363

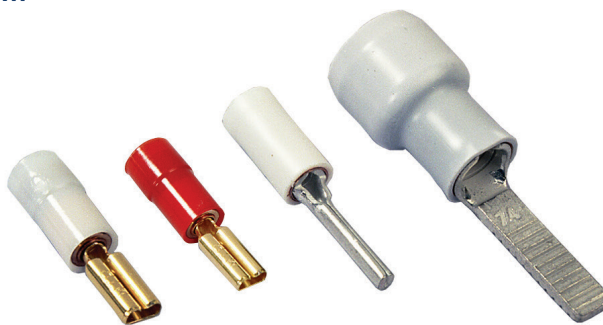
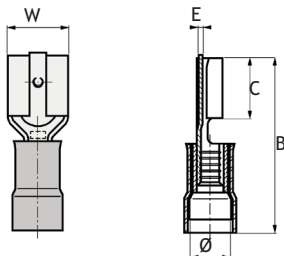

Cross section (mm ²)	Ref.	Ref. SNCF	Coating	For tabs	W	B	C	E	Ø	SNCF code	Crimping tool
	51027	7-847-1902	Gold	2.8 x 0.5	3.8	19.5	6.5	0.25	3.6	0-391-6844	TH1-90
0.34 - 1.5 ●	51081-2	7-847-4728	Tin	5 x 0.8	6.4	21	7.7	0.5	3.6	0-391-6840	THIS
	51181-2	7-847-4700	Tin	6.35 x 0.8	7.7	21	7.7	0.5	3.6		
0.34 - 1.5 ○	51328	7-847-1900	Gold	2.8 x 0.3	3.8	19.5	6.5	0.25	3.6	0-391-6844	TH1-90
	51028	7-847-1901	Gold	2.8 x 0.5	3.8	19.5	6.5	0.25	3.6		
1 - 2.5 ●	51131-2	7-847-4999	Tin	5 x 0.8	7.7	21	7.7	0.5	4.8	7-847-7141	TH2-S
	51231-2	7-847-4797	Tin	6.35 x 0.8	7.7	20.2	7.7	0.5	4.8	7-847-7141	TH1-S
1 - 3.18 ●	51261-2NR	7-847-6798	Tin	6.35 x 0.8	7.7	27.5	7.7	0.5	8.8	0-391-6837	TH3-2

Pre-insulated blade and pins terminals

- Material: tin-plated copper
- Insulation according to EN 45545
- SNCF Drawing: VZA 17692/000003.

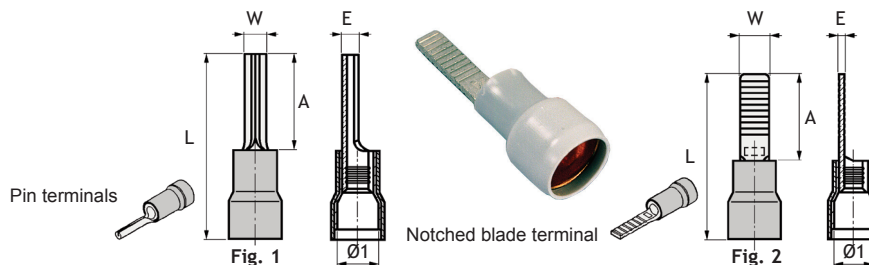

Cross section (mm ²)	Ref.	Ref. SNCF		W	A	L	Ø1	E	SNCF code	Crimping tool
0.34 - 1.5 ●	51220-2	7-847-5051	Fig. 1	1.9	10	22.5	3.6	1.9	0-391-6840	THIS
	51225-2	7-847-5556	Fig. 2	2.9	10.2	21	3.6	0.8		THIS*
0.34 - 1.5 ○	51220-2 BC	7-847-5359	Fig. 1	1.9	10	22.5	3.6	1.9	0-391-6840	THIS
	51225-2 BC	7-847-5890	Fig. 2	2.9	10.2	21	3.6	0.8		THIS*
1 - 2.5 ●	51222-2	7-847-5002	Fig. 1	1.8	10	22	4.8	1.8	7-847-7141	TH2S
	51226-2	7-847-5555	Fig. 2	3.9	11.5	22	4.8	0.8		
1 - 3.18 ●	53226-2 R	7-847-6038	Fig. 2	3.9	14	30	8.8	0.9	0-391-6837	TH3-2
1 - 3.18 ●	53226-2 NR	7-847-6037	Fig. 2	3.9	14	30	8.8	0.9	0-391-6837	TH3-2
2.6 - 6 ●	51223-2 JN	7-847-5393	Fig. 1	2.5	12	28	8.8	2.5	0-391-6837	TH3-2
	51227-2 JN	7-847-5370	Fig. 2	3.9	12	30.5	8.8	1.0		
7.42 ●	51227-2G	7-847-6352	Fig. 2	3.9	16	32	8.8	1.2	0-391-6837	TH3-2

For on edge crimping, use TH1-90 tool (SNCF code :0-391-6844).

Unless otherwise stated, all dimensions are in millimeters.

Pre-insulated butt connectors with inspection window

- Material: tin-plated copper.
- Insulation according EN 45545.
- SNCF drawing: VZA 17692/000004.

Standards:

NFF 00363

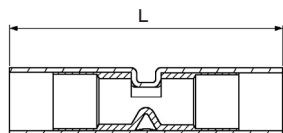

Cross section (mm ²)	Ref.	Ref. SNCF	L	Ø	SNCF code	Crimping tool
0.34 - 1.5	51391	7-847-4323	32	3.6	0-391-6840	TH1S
1 - 2.5	51402	7-847-4344	32	4	7-847-7141	TH2S
2.6 - 6	51413	7-847-4120	41.5	5.5	0-391-6837	TH3-2

Unless otherwise stated, all dimensions are in millimeters.

Copper tubular lugs

- Material: tin-plated copper.
- SNCF drawing: VZA 17692/000006.

Standards:

NFF 00363

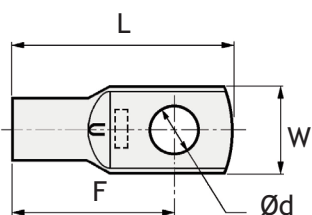

Cross section (mm ²)	Ref.	Pckg.	Ref. SNCF	W	L	Ø d	F	SNCF code Tools
6.6 - 10	ELS40	1000	7-847-7211	14	34	4.2	26	0-391-6832 or 0-391-6850 + 0-391-6851
	ELS50	1000	7-847-7212	14	34	5.2	26	
	ELS60	1000	7-847-7213	14	34	6.4	26	
	ELS80	1000	7-847-7214	14	34	8.3	26	
	ELS100	1000	7-847-7215	16.5	36	10.3	28	
	ELS120	1000	7-847-7216	16.5	36	12.8	28	
16	FLS60	500	7-847-7217	15	37	6.4	29	0-391-6832 or 0-391-6850 + 0-391-6852
	FLS80	500	7-847-7218	15	37	8.3	29	
	FLS100	500	7-847-7219	17	38	10.3	30	
	FLS120	500	7-847-7220	17	38	12.8	30	
25	TN25-5	500	7-847-5853	14.3	45	5.2	35	0-391-6832 or 0-391-6850 + 0-391-6853
	TN25-6	500	7-847-5854	14.3	45	6.4	35	
	TN25-8	500	7-847-5855	14.3	45	8.3	35	
	TN25-10	500	7-847-4147	17	45	10.3	35	
	TN25-12	500	7-847-7221	17	45	12.8	35	
	TN25-14	200		21.5	53.5	14.5	39	
35	TN35-6	250	7-847-7222	18	50	6.4	39	0-391-6832 or 0-391-6850 + 0-391-6851
	TN35-8	250	7-847-7223	18	50	8.3	39	
	TN35-10	250	7-847-7224	18	50	10.3	39	
	TN35-12	250	7-847-7225	18	50	12.8	39	
50	TN50-6	200	7-847-5860	19	58	6.4	46	0-391-6850 + 0-391-6852
	TN50-8	200	7-847-5861	19	58	8.3	46	
	TN50-10	200	7-847-5862	19	58	10.3	46	
	TN50-12	200	7-847-5863	19	58	12.8	46	
	TN50-14	200		19	58	14.5	46	
60	TN60-6	100		22	60	6.4	46	
	TN70-6	100		22	66	6.4	51	
	TN70-8	100	7-847-5864	22	66	8.3	51	
70	TN70-10	100	7-847-5865	22	66	10.3	51	0-391-6850 + 0-391-6853
	TN70-12	100	7-847-5866	22	66	12.8	51	
	TN70-14	200		22	66	14.5	51	
	TN70-16	200		22	66	16.5	51	

Unless otherwise stated, all dimensions are in millimeters.

Copper butt connectors

- Material: tin -plated copper.
- SNCF drawing: VZA 17692/000005.

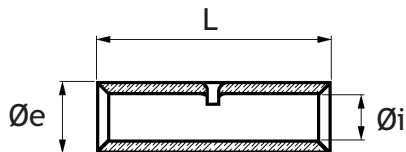

Standards:

NFF 00363

Cross section (mm ²)	Ref.	Ref. SNCF	Pckg.	L	Ø i	Ø e	SNCF code Tools
0.3 - 1.5	MJ1.5	7-847-4598	100	14.5	1.7	3.2	7-931-0114
1 - 2.5	MJ2.5	7-847-5358	100	14.5	2.2	3.9	7-931-0114
2.6 - 6	MJ3S	7-847-5357	100	14.5	3.2	4.9	7-931-0114
6.6 - 10	MJ10SH	7-847-7200	100	30	4.7	8	0-391-6832 ou 0-391-6850 + 0-391-6851
16	MJ16SH	7-847-7201	100	35	5.6	9	0-391-6832 ou 0-391-6850 + 0-391-6852
25	MJ25SH	7-847-7202	100	35	7.4	10.4	0-391-6832 ou 0-391-6850 + 0-391-6853
35	MJ35SH	7-847-7203	100	35	8.6	11.9	0-391-6832 ou 0-391-6850 + 0-391-6851
50	MJ50SH	7-847-7204	50	45	10.4	13.9	0-391-6850 + 0-391-6852
70	MJ70SH	7-847-7205	50	50	12.1	15.9	0-391-6850 + 0-391-6853
95	MJTN95		25	55	14.5	18.5	
120	MJTN120		50	56	16.5	21	
150	MJTN150		10	70	18	23	
185	MJTN185		25	80	20.6	26	
240	MJTN240		25	90	23	29	
300	MJTN300		25	95	26	33	

Unless otherwise stated, all dimensions are in millimeters.

BLUE ADVANCED

The future of crimping!

- Qualified to NFF 00363 standard.
- Mobile & ergonomic tool.
- High crimping performance.



Ref. : ET300

05

I Tooling

Selection table	P. 54	
Tooling for pre-insulated products	P. 56	
Electro-hydraulic tool for pre-insulated terminals	P. 58	NEW
Crimping tools for copper tubular lugs and butt connectors	P. 59	
Cycle counter for connectable hydraulic presses	P. 70	NEW
Hydraulic pumps and sets	P. 71	
Cutting pliers, plug in plier, plug out plier and cable-cutters	P. 73	
Number of crimps by tool type	P. 75	
Go-no-go gauge	P. 76	NEW

Selection table

Hand crimping tools and electro hydraulic crimping tool



	Hand crimping tools					
	Hand crimping tools					Electro hydraulic crimping tool
	TH1-TH1S	TH1-90	TH2-TH2S	TH3	TH3-2	ET300
Pre-insulated products	Page 56	Page 56	Page 57	Page 57	Page 57	Page 58
Pre-insulated terminals, disconnects, pins and butt connectors with inspection window	0.34 to 1.5 mm ²		1 to 2.5 mm ²			0.34 to 6 mm ² *
Gilded disconnects 2.8 mm and blade terminals (on edge crimping)		0.34 to 1.5 mm ²				
Terminals 51190 series and white disconnects (max. insulating Ø : 6.8 mm)				1 to 2.5 mm ²		1 to 2.5 mm ²
Terminals C3P+ series and yellow disconnects (max. insulating Ø : 6.8 mm)				2.6 to 6 mm ²		2.6 to 6 mm ²
Terminals C3P+ series, pins, disconnects yellow and black (max. insulating Ø : 8.8 mm)					1 to 2.5 mm ²	1 to 2.5 mm ²
Terminals C3P+ series, pins and disconnects yellow striped black (max. insulating Ø : 8.8 mm)					2.6 to 6 mm ²	2.6 to 6 mm ²

*Except butt connectors with inspection window.

Crimping tools

Mechanical, hydraulic, electro-hydraulic and hydraulic sets.



Hydraulic pumps and sets 700 bars

Hydraulic sets		
SPM 4095K	PA 133 K	SPT21-585KCM
Page 71	Page 71	Page 72

	Tooling									
	Mechanical tools	Hydraulic and electrohydraulic tools								
	PMM1CF	EID51	ESD50	ESU137	TR1461	TR1462	SU130K	VF130K	SU210K	VF210K
Tubular lugs and connectors	Page 59	Page 61	Page 62	Page 64	Page 67	Page 67	Page 68	Page 68	Page 69	Page 69
Medium power pre-insulated copper tubular lugs ELP-FLP - NP series				10 to 25 mm ²	10 to 25 mm ²	10 to 25 mm ²				
Copper tubular lugs C3P...NUE-ELS-FLS-TN series	2.6 to 70 mm ²	2.6 to 70 mm ²	2.6 to 70 mm ²	10 to 240 mm ²	10 to 70 mm ²	10 to 95 mm ²	10 to 150 mm ²	10 to 150 mm ²	10 to 300 mm ²	10 to 300 mm ²
Copper tubular lugs TR series									95 to 500 mm ²	95 to 500 mm ²
Copper tubular lugs TRS series							95 to 120 mm ²	95 to 120 mm ²	95 to 400 mm ²	95 to 400 mm ²
Aluminium tubular lugs AL series							50 to 95 mm ²	50 to 95 mm ²	50 to 460 mm ²	50 to 460 mm ²

Hydraulic compression heads

Tooling for pre-insulated products

Hand crimping tools for pre-insulated terminals, disconnects, pins, blades and butt connectors.

Hand crimping tool for pre-insulated products

 0.34 to 1.5 mm²

- Crimping of red pre-insulated terminals, disconnects, pins, blades and window butt connectors from 0.34 to 1.5 mm².
- Aluminium body.
- Exceptional low gearing.
- High quality crimping by linear movement of dies.
- Adjustable crimping of cable insulation by eccentric.
- Safety ratchet.
- Positioner stopper.
- Crimping dies identification reference mark: 1 dash.

Delivered in individual box with control and instruction leaflet.

- Length: 290 mm.
- Weight: 0.500 kg.

TH1: delivered with stopper HD20 for terminals, disconnects and pins.

Ref.	SNCF
TH1	7-847-7140

TH1S: delivered with stopper HF20 for terminals, disconnects, pins and butt connectors.

Ref.	SNCF
TH1S	0-391-6840

Complementary accessory: PG1: Go-no-go gauge.



Hand tool for crimping on edge of pre-insulated disconnects and blades

 0.34 to 1.5 mm²

- Crimping on edge of 2.8 pre-insulated disconnects and blade from 0.34 to 1.5 mm².
 - Aluminium body.
 - Exceptional low gearing.
 - High quality crimping by linear movement of dies.
 - Adjustable crimping of cable insulation by eccentric.
 - Safety ratchet.
 - Positioner stopper.
 - Crimping dies identification reference mark: 1 dash.
- Delivered in individual box with control and instruction leaflet.*
- Length: 290 mm.
 - Weight: 0.500 Kg.
 - Delivered with stopper HD28-90.

Ref.	SNCF
TH1-90	0-391-6844

Complementary accessory: PG1: Go-no-go gauge.

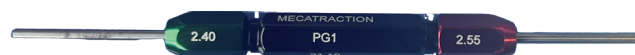

Go-no-go gauge page 76

Hand crimping tool for pre-insulated products



- Crimping of blue pre-insulated terminals, disconnects, pins, blades and window butt connectors from 1.0 to 2.5 mm².
 - Aluminium body.
 - Exceptional low gearing.
 - High quality crimping by linear movement of dies.
 - Adjustable crimping of cable insulation by eccentric.
 - Safety ratchet.
 - Positioner stopper.
 - Crimping dies identification reference mark: 2 dashes.
- Delivered in individual box with control and instruction leaflet.*
- Length: 290 mm.
 - Weight: 0.500 kg.

TH2: delivered with stopper HF20 for terminals, disconnects, pins and blade terminals.

Ref.	SNCF
TH2	7-847-7141

TH2S: delivered with stopper HF20 for terminals, disconnects, pins and butt connectors.

Ref.	SNCF
TH2S	7-847-7141

Complementary accessory: PG2: Go-no-go gauge.



Hand crimping tool for pre-insulated products



- Strong and practical steel tools.
 - High quality crimping by linear movement of dies.
 - Adjustable crimping of cable insulation by a pin.
 - Safety ratchet.
 - Positioner stopper ATH23.
 - Crimping dies identification reference mark: 3 dots.
- Delivered in individual box with control and instruction leaflet.*
- Length: 330 mm - Weight: 0.905 Kg.
 - Handles colour: TH3 = 1 yellow and one white - TH3-2 = one yellow and one black.

TH3: max. insulating diameter: 6.8 mm

- Crimping of white terminals 51190 series and disconnects from 1 to 2.5 mm².
- Crimping of yellow terminals C3P series and disconnects from 2.6 to 6 mm².

Ref.	SNCF
TH3	7-847-7142

TH3 : max. insulating diameter: 8.8 mm

- Crimping of black terminals 51190 series and disconnects from 1 to 2.5 mm²
- Crimping of yellow black terminals C3P series and disconnects from 2.6 to 6 mm².

Ref.	SNCF
TH3-2	7-847-7143 ou 0-391-6837

Complementary accessory: PGH3: Go-no-go gauge.



Go-no-go gauge page 76

Electro-hydraulic crimping tool for pre-insulated lugs, clips and butt splices

Electro-hydraulic crimping tool for pre-insulated products

0.34 to 6 mm²

The ET300 has been designed with the operator's usual crimping gestures in mind, to develop a tool that is intuitive and ergonomic to use. The remote electro-hydraulic unit, powered by a MAKITA battery, is connected to the crimping hand tool by a 3 m flexible.

Kit ET300

Ref.	
ET300K1BLCM	
Kit composition	Ref.
Crimping tool	ET300
2 batteries	BL1850B
Charger 220V	CLM1890HC

Accessories:

Die	Stopper	Go-no-go gauge
ET331	ETB31 ETB31-90*	PG1
ET332	ETB32 ETB30**	PG2
ET333		
ET333-2	ETB33	PGH3

*for on edge crimping (90°).

**specific stopper ET332 for blue disconnect.



ET331



ET332



ET333



ET333-2



Go-no-go gauge page 76

Mechanical crimping tool for non insulated lugs and splices

Hand crimping tool PMM1CF

POWER 50 kN

- Hand crimping tool with reversible dies.
 - Length: 420 mm.
 - Weight: 2 Kg.
- Delivered in metal boxe with working leaflet.

Ref.	SNCF
PMM1CF	7-847-7285

Complementary accessories:

- Control gauge.

Ref.
PGM1

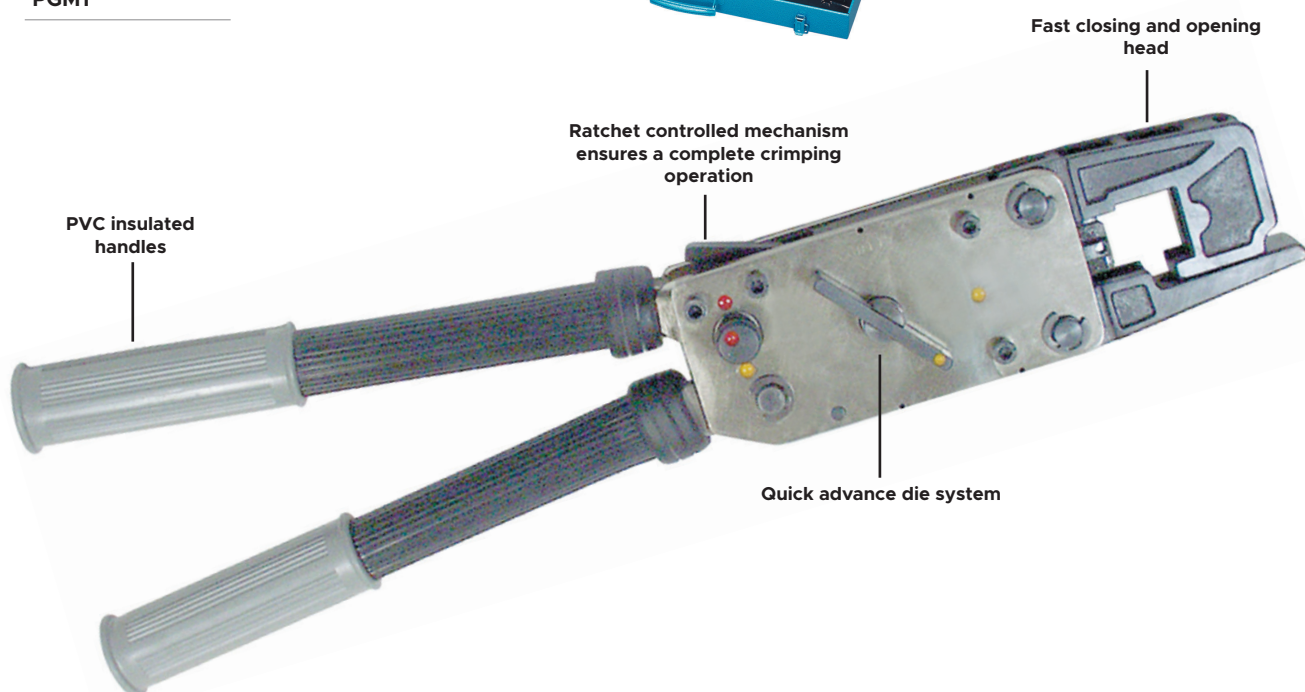

Dies	Cross section (mm ²)	Terminals series	Ref.	SNCF code
	10	ELS	H1-10-35F	7.847.7286
	16	FLS	H1-16-50F	7.847.7287
	25	TN25	H1-25-70F	7.847.7288
	35	TN35	H1-10-35F	7.847.7286
	50	TN50	H1-16-50F	7.847.7287
	70	TN70	H1-25-70F	7.847.7288

Note: **in red**: side of die to be used.

B-Crimping

A crimping solution for railway applications that complies with IEC 61238-1-3, a new deal for power connectors on rolling stock!

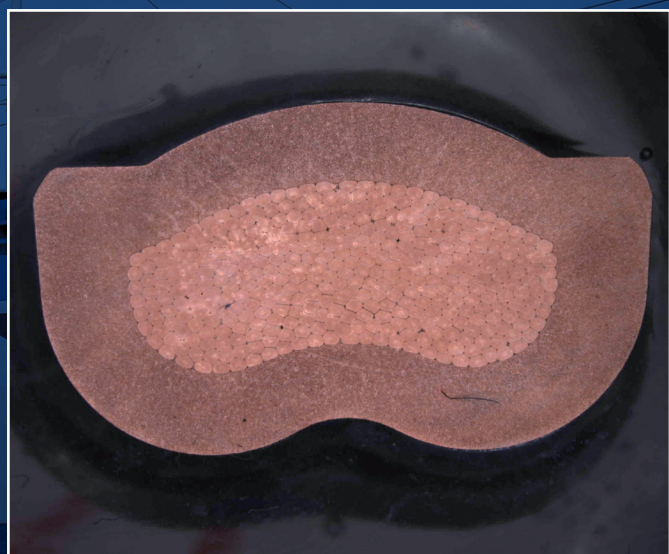

With over 20 years' experience, MECATRACTION has mastered the technology of B crimping technology, particularly on flexible cables, and the optimisation of compaction and variability of sections to obtain:

- Optimised compaction.
- Uniform strand compression.
- A crimp that prevents the formation of sharp edges, thus protecting the insulation.

For further information, please contact us:
33 (0)5 55 73 89 80
service.technico@mecatraction.com
www.mecatraction.com

Cordless electro-hydraulic compression tool - 50 kN to crimp tubular lugs and butt connectors

Electro-hydraulic tool

10 to 70mm²

EID51 is designed for industrial applications requiring efficiency and manoeuvrability. Its in-line shape provides excellent ergonomics and access to the tightest working areas. The 18V Li-Ion batteries provide long and reduced weight. Its USB connection provides access to operating parameters and crimping history. Reversible die type D5.

- 18V Li-Ion battery.
- In-line design.
- Nickel-plated head swivels 360.
- Quick opening head.
- USB connector with cycle memory.
- Dimensions 400 x 125 x 82 mm.
- Weight with battery: 2.380 kg.

Electro-hydraulic press kit EID51

Ref.	Item code
EID51KCM	7512176

Kit composition	Ref.
Crimping tool	EID51
1 batterie	BL1820I
Charger 220 V	CH1830HC
Metallic carry case	CM3EID51



Crimping dies:

Dies	Cross section (mm ²)	Terminals series	Ref.	SNCF code
	10	ELS	H1-10-35F	7.847.7286
	16	FLS	H1-16-50F	7.847.7287
	25	TN25	H1-25-70F	7.847.7288
	35	TN35	H1-10-35F	7.847.7286
	50	TN50	H1-16-50F	7.847.7287
	70	TN70	H1-25-70F	7.847.7288

Note: **in red**: side of die to be used.

Cordless electro-hydraulic compression tool - 50 kN to crimp tubular lugs, splices and other connectors

Electro-hydraulic compression tool ESD50

POWER 50 kN

SPEED - AUTONOMY

- Output force: 50 kN.
- Stroke: 13 mm.
- Autonomy: 200 to 500 crimping operations with battery 5.0 Ah.
- Cycle time: 2 to 4 s depending on the section.
- Dimensions: 350 x 310 x 72 mm.
- Weight: 4.0 kg (including the battery).

New features:

- Electronic control of the cycle.
- Return programming according to the user, either automatic or manual.
- Automatic or manual return stroke.
- Automatic stop at the end of the cycle.
- 2-stage hydraulic pump with pilot-operated valve which increases efficiency between 20 and 40%.
- Return sound signal.
- New PC software for diagnosis and analysis of data.



THE TOOL POWER 2

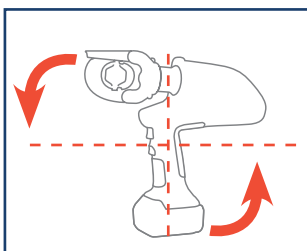

Optimum ergonomics thanks to the balance of the tool. Can be used by right or left-handed people.



Comfortable and accurate handling thanks to the shape and the materials used in the handle.



Electronic controlled function parameters, warning lights and USB interface.



Service indicator lights informing about the battery charge level and service control if necessary.

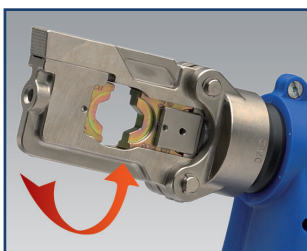

180° swiveling nickel-plated head.

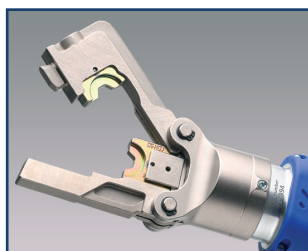

Easy head opening.

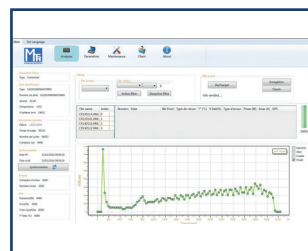

With this software, it is possible to configure the tool, record the crimping data and analyze the cycles already done.



Lithium-ion 18 V battery with increased life expectancy and without any memory effect.

Electro-hydraulic compression tool kit - ESD50

Ref.	
ESD50K1BLCM	
Kit composition	Ref.
Crimping tool	ESD50
2 batteries 18 V / 5 Ah	BL1850B
Charger 220 V	CLM1890HC
Metallic carry case	CMESD50



Additional equipment for ESD50:

Metallic carry case

- Ideal for transport and storage.
- Adapted to each model.

Ref.	
CMESD50	

Fast charger

- Charger with display which identifies the state of the battery and the conditions of load.
- Charging time: 36 min.
- Weight: 0.85 Kg.
- Voltage: 220-240 V AC.
- Plug: Standard EU, others on request.



Ref.	
CLM1890HC	

Battery

- Li-Ion technology without memory effect.
- Voltage: 18 V.
- Capacity: 5.0 Ah.
- Weight: 0.64 Kg.

Ref.	
BL1850B	



BE2 support

- Support for fixing our BE2 crimping tools to a workbench.
- Compatible with our references: ESD50, ESDC60, ESDC80, ESU137.

Ref.	
SUPPORT OUTIL BE2	



Crimping dies:

Dies	Cross section (mm²)	Terminals series	Ref.	SNCF code
	10	ELS	H1-10-35F	7.847.7286
	16	FLS	H1-16-50F	7.847.7287
	25	TN25	H1-25-70F	7.847.7288
	35	TN35	H1-10-35F	7.847.7286
	50	TN50	H1-16-50F	7.847.7287
	70	TN70	H1-25-70F	7.847.7288

Note: **in red**: side of die to be used.

Electro-hydraulic press - 120 kN for crimping insulated and tubular lugs

Hydraulic press with integrated electric motor ESU137

POWER 120 KN

SPEED - AUTONOMY

- Output force: 120 kN.
- Stroke: 27 mm.
- Autonomy: 100 to 220 crimping operations with battery 5.0 Ah.
- Punching cycle time: 7 to 12 s depending on the section.
- Crimping cycle time: 5 to 8 s depending on the section.
- Dimensions: 400 x 310 x 72 mm.
- Weight: 5.9 kg (including the battery).

New features:

- Electronic control of the cycle.
- Return programming according to the user, either automatic or manual.
- Automatic or manual return stroke.
- Automatic stop at the end of the cycle.
- 2-stage hydraulic pump with pilot-operated valve which increases efficiency between 20 and 40%.
- Return sound signal.
- New PC software for diagnosis and analysis of data.



THE TOOL POWER 2

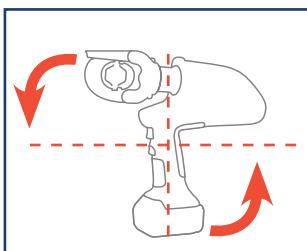

Optimum ergonomics thanks to the balance of the tool. Can be used by right or lefthanded people.



Comfortable and accurate handling thanks to the shape and the materials used in the handle.



Electronic controlled function parameters, warning lights and USB interface.



Service indicator lights informing about the battery charge level and service control if necessary.

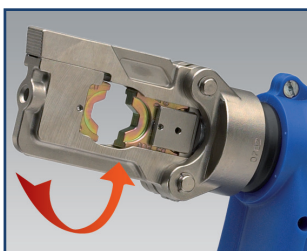

180° swiveling nickel-plated head

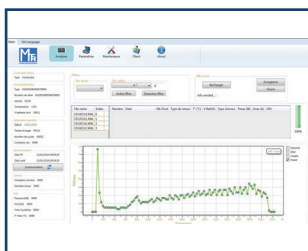

With this software, it is possible to configure the tool, record the crimping data and analyze the cycles already done.



Lithium-ion 18 V battery with increased life expectancy and without any memory effect.

ESU137 electro-hydraulic tool kit

Ref.

ESU137K1BLCM

See accessories for adapters required for the dies used.

Kit composition	Ref.
Crimping tool	ESU137
2 batteries 18 V / 5 Ah	BL1850B
Charger 220 V	CLM1890HC
Metallic carry case	CMES120KN



Additional equipment for ESU137:

Metallic carry case

- Ideal for transport and storage.
- Adapted to each model.

Ref.

CMES120KN

Fast charger

- Charger with display which identifies the state of the battery and the conditions of load.
- Charging time: 36 min.
- Weight: 0.85 Kg.
- Voltage: 220-240 V AC.
- Plug: Standard EU, others on request.



Ref.

CLM1890HC

Battery

- Li-Ion technology without memory effect.
- Voltage: 18 V.
- Capacity: 5.0 Ah.
- Weight: 0.64 Kg.



Ref.

BL1850B

BE2 support



- Support for fixing our BE2 crimping tools to a workbench.
- Compatible with our references: ESD50, ESDC60, ESDC80, ESU137.



Ref.

SUPPORT OUTIL BE2



Crimping dies:

Dies	Cross section (mm ²)	Terminals series	Ref.	
			Dies	Adapters
 	10	pre-insulated ELP series	ELP460	U137-460
	16	pre-insulated FLP series	FLP460	U137-460
	25	pre-insulated NP series	NP460	U137-460
	10	non insulated ELS series	ELS460 ou C12 ELS	U137-460 or U137C12
	16	non insulated FLS series	FLS460 ou C12 FLS	U137-460 or U137C12
	25	non insulated TN 25 series	C12TN25	U137C12
	35	non insulated TN35 series	C12TN35	U137C12
	50	non insulated TN 50 series	C12TN50	U137C12
	70	non insulated TN70 series	C12TN70	U137C12
	95	non insulated TN95 series	C12TN95	U137C12
	120	non insulated TN120 series	C12TN120	U137C12
	150	non insulated TN150 series	C12TN150	U137C12
	185	non insulated TN185 series	C12TN185	U137C12
	240	non insulated TN240 series	C12TN240	U137C12

Positioning stoppers

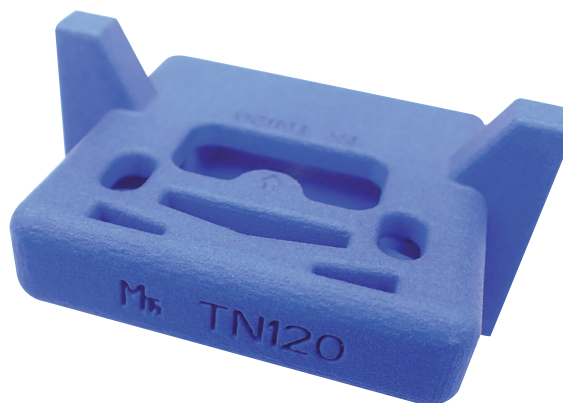
Mobiles stoppers for TN railway lugs from 25 to 120 mm²



Cross section (mm ²)	Ref.	Marking	Ref. Stopper	Tools
25	TN25-5	MTR TN25	BSTN25	 
	TN25-6			
	TN25-8			
	TN25-10			
35	TN35-6	MTR TN35	BSTN35	
	TN35-8			
	TN35-10			
50	TN50-6	MTR TN50	BSTN50	
	TN50-8			
	TN50-10			
60	TN60-8	MTR TN60	BSTN60	
	TN60-10			
	TN60-12			
70	TN70-8	MTR TN70	BSTN70	
	TN70-10			
	TN70-12			
95	TN95-10	MTR TN95	BSTN95	
	TN95-12			
	TN95-14			
120	TN120-10	MTR TN120	BSTN120	
	TN120-12			
	TN120-14			
	TN120-16			

BSH137 for ESU137 press

Support BSH210 for VF210 cylinder



Hydraulic hand crimping tool and connectable hydraulic compression heads for terminals

Hydraulic hand crimping tool 10 to 70 mm²

- Hand crimping tool.
 - Power: 55 kN.
 - Crimping from 10 to 70 mm².
 - Two pressure level.
 - Automatic release.
 - Die lock system.
 - Head tilting on 180°.
- Delivered in box with working leaflet.

Ref.	SNCF
TR1461	7-847-7296



Connectable hydraulic compression head 10 to 95 mm²

- Connectable hydraulic compression head.
- Power: 100 kN.
- Crimping from 10 to 95 mm².
- anti-corrosion coating (nickel).
- Die locking system.
- To be connected to 700 bars hydraulic pump or sets.
- Delivered with female semi-coupler p/n: RKFM38NPT.

Ref.
TR1462



Crimping dies:

Dies	Cross section (mm ²)	Terminals series	Ref.	SNCF code
	10	pre-insulated ELP series	ELP460	7.847.7303
	16	pre-insulated FLP series	FLP460	7.847.7304
	25	pre-insulated NP series	NP460	7.847.7305
	10	non insulated ELS series	ELS460	7.847.7297
	16	non insulated FLS series	FLS460	7.847.7298
	25	non insulated TN 25 series	TN25-460	7.847.7299
	35	non insulated TN35 series	TN35-460	7.847.7300
	50	non insulated TN 50 series	TN50-460	7.847.7301
	70	non insulated TN70 series	TN70-460	7.847.7302
	95*	non insulated TN95 series	TN95-460	

*only with TR1462 tool.

Pluggable hydraulic compression head for tubular lugs

Connectable hydraulic compression head SU130K

POWER 130 kN

- To be connected to 700 bars hydraulic pump or sets.
- Crimping of non insulated terminals from 10 to 150 mm².
- Anti-corrosion coating (nickel).
- Length: 215 mm.
- Weight: 3.200 kg.

Ref.

SU130K



Connectable hydraulic compression head VF130K with closed head

POWER 130 kN

- To be connected to 700 bars hydraulic pump or sets.
- Crimping of non insulated terminals from 10 to 150 mm².
- Anti-corrosion coating (nickel).
- Length: 220 mm.
- Weight: 3.400 kg.

Ref.

VF130K



Crimping dies:

Dies	Cross section (mm ²)	Terminals series	Crimping dies SU130K/VF130K
	For ELS / FLS series		
	10	ELS	ELSV13
	16	FLS	FLSV13
	For TN series		
	25	TN25	TN25V13
	35	TN35	TN35V13
	50	TN50	TN50V13
	70	TN70	TN70V13
	95	TN95	TN95V13
	120	TN120	TN120V13
	150	TN150	TN150V13
	For TRS series		
	95	TRS95	TRS95V13
	120	TRS446	TRS446V13
	120	TRS448	TRS448V13
For AL series			
50	AL50	AL50V13	
60	AL60	AL60V13	
70	AL70	AL70V13	
95	AL95	AL95V13	

Pluggable hydraulic compression head SU210K

POWER 200 kN

- Crimping of non insulated terminals from 10 to 150 mm².
- Anti-corrosion coating (nickel).
- To be connected to 700 bars hydraulic pump or sets.
- Delivered with female semi-coupler p/n : RKF-M38NPT.
- Length: 260 mm.
- Weight: 5.8 Kg.

Accessories

Die holder **S21**

Ref.

SU210K



Pluggable hydraulic compression head VF210K with closed head

POWER 200 kN

- Crimping of non insulated terminals from 10 to 150 mm².
- Anti-corrosion coating (nickel).
- To be connected to 700 bars hydraulic pump or sets.
- Delivered with female semi-coupler p/n : RKF-M38NPT.
- Length: 275 mm.
- Weight: 6.2 Kg.

Accessories



Die holder **S21**

Ref.

VF210K



Crimping dies:

Dies	Cross section (mm ²)	Terminals series	Dies p/n SU210K/ VF210K + S21 die holder	Cross section (mm ²)	Terminals series	Dies p/n SU210K/ VF210K + S21 die holder	Cross section (mm ²)	Terminals series	Dies p/n SU210K/ VF210K + S21 die holder
ELS/FLS series						AL serie			
	10	ELS	ELSV20	95	TRS95	TRS95V20	50	AL50	AL50V20
	16	FLS	FLSV20	120	TRS446	TRS446V20	60	AL60	AL60V20
	TN serie			120	TRS448	TRS448V20	70	AL70	AL70V20
	25	TN25	TN25V20	150	TRS450	TRS450V20	95	AL95	AL95V20
	35	TN35	TN35V20	185	TRS452	TRS452V20	120	AL120	AL120V20
	50	TN50	TN50V20	240	TRS455	TRS455V20	150	AL150 - AL150B	AL150V20
	70	TN70	TN70V20	240	TRS453	TRS453V20	185	AL185	AL185V20
	95	TN95	TN95V20	400	TRS456	TRS456V20	240	AL240	AL240V20
	120	TN120	TN120V20	185	TRS185 - TRS185-1B	TRS185V20	300	AL300	AL300V20
	150	TN150	TN150V20	240	TRS240 - TRS240-1B	TRS240V20	460	AL460	AL460V20
	185	TN185	TN185V20	240	TRS242-12	TRS258V20			
	240	TN240	TN240V20	240	TRS400	TRS400V20			
	300	TN300	TN300V20	400	TRS400	TRS400V20			
	TR serie			50	TRS262	TRS262V20S (sertissage sur âme)			
	95	TR95	TR95V20			TRS262V20F (sertissage sur isolant)			
	120	TR120	TR120V20	95	TRS246	TRS246V20S			
	150	TR150	TR150V20			TRS246V20F			
	185	TR185	TR185V20						
	240	TR240	TR240V20						
	300	TR300	TR300V20						
	400	TR400	TR400V20						
	500	TR500	TR500V20						

Cycle counter for connectable hydraulic crimping tools

Cycle counter KCHTA10

- Dimensions (without couplings): H=53 x w=50 x L=80 mm. (L box alone= 50 mm).
- Weight (without coupling): 620 g.
- Communicating tool: three-color indicator/warning LED.
- Micro-USB connection for computer monitoring.
- Lifetime: 50 000 cycles.
- Battery life: 5 years.

Micro-USB connection for access via the CT Diag software to the following information:

- Tool type
- Serial number.
- Commissioning date.
- Number of cycles.
- Remaining number of cycles.
- 10 last service interventions.

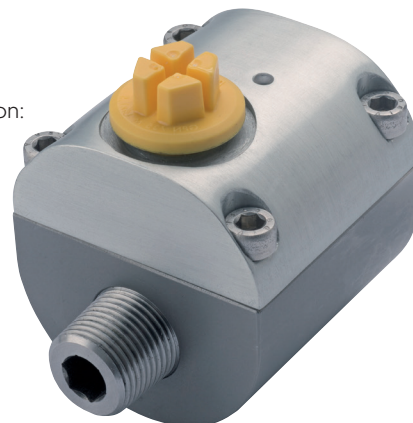

Item code	Ref.	Connection
7510029	KCHTA10M38NPT	2x3/8 NPT males



3 color LED indicator gives information about the hydraulic tool condition (flashes 3 times after each crimping operation).

- Enables monitoring and preventive maintenance during the whole lifetime of the tool.

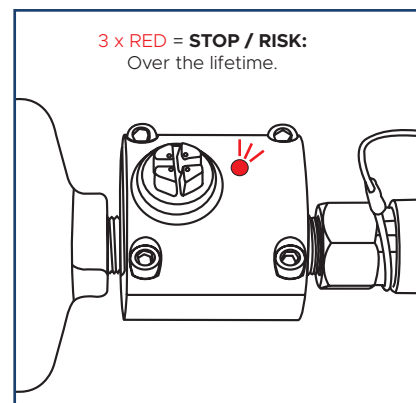
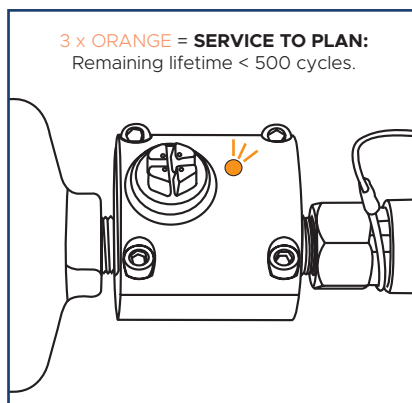
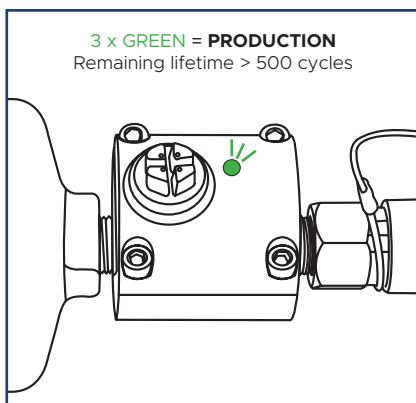

Hydraulic Pumps

Hydraulic pump SPM4095

- Length: 700 mm.
- Weight: 12.9 kg.
- Pressure: 700 bar.
- 2-speed foot pump.
- Automatic release.
- U-shaped base offering 1 high level of stability.
- Oil tank: 1 l.
- Fitted with 3 m hydraulic hose with 1 RMKF38NP coupling.

Box on request:
VAL 22CR.

Ref.

SPM4095K

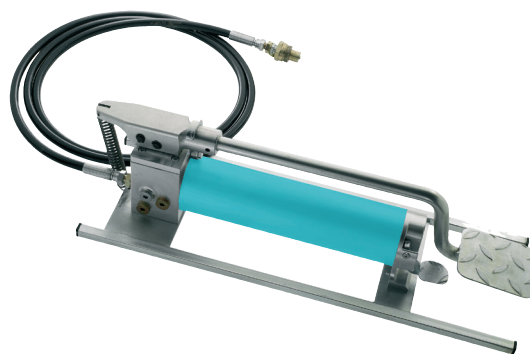

Hydraulic pump PA133

- Length: 400 mm.
- Weight: 4.900 kg.
- Pressure: 700 bar.
- Oil tank: 0.6 l.
- Fitted with 1/2 female coupling.
- Single-stage air motor pump.
- Compressed air supply: 7 bar max.
- 3-way valves maintain pressure when air supply is interrupted.
- Fitted with half female coupling (RFK-M38NPT).
- Hydraulic hoses.

Ref.

PA133K

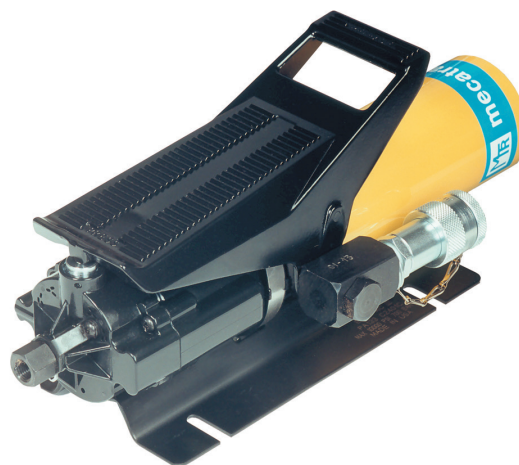

Electro-hydraulic Pumps

Portable and compact electro-hydraulic set SPT21-585KCM

- Dimensions: 270 x 200 x 400 mm.
- Weight: 15 kg.
- Flow rate: 0 - 20 bar: 2.60 l/min.
20 - 700 bar: 0.32 l/mn.
- Fitted with female half-coupling (RFK-M38NPT).
- Hydraulic hoses.

Ref.
SPT21-585KCM

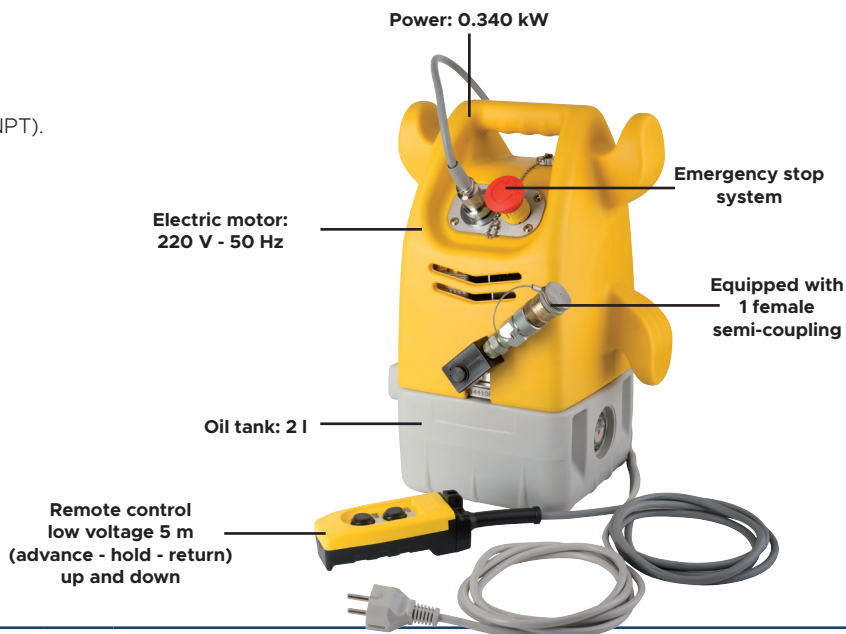

Hydraulic couplers

- Standard equipments for our tools.
Type of coupler when ordering.

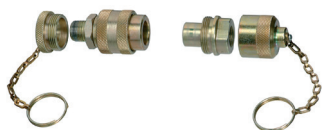

Type	Ref.	Dimensions (Threading in ")	Description
K	RMKF38NPT	3/8 - 18 NPT	Male coupler, assembly through 3/8 NPT threaded hole
	RFKM38NPT	3/8 - 18 NPT	Female coupling, assembly through through 3/8 NPT threaded male socket

Hydraulic hoses with couplers 3/8



Item code	Ref.	Dimensions
7510021	F4622K	1.80 m
7510031	F4623K	3.00 m
7510041	F4626K	6.00 m

Hydraulic oils



Item code	Ref.	Applications	Capacity
7516220	HF95X	PA133 and P39	1 L
7516230	B2XV32	SPT21-585 and SPM4095	2 L

Cutting plier, plug-in plier, plug-out plier

Cutting plier HS6000

The HS6000 cutting plier has been designed for an easy and precised cut thanks to its blades micro-serrated and its robustness. Handles and the general form of this pliers enables excellent handling.

Cannot cut stell

- Length: 150 mm.
- Weight: 0.09 kg.

Ref.

HS6000



Plug-in plier MO-66105

The plier MO-66105 allows the easy plug in red and blue disconnects terminals of 2.8, 4.8, 5 and 6.35 mm.

- Chrome-vanadium steel body.
- Insulated handles up to 1000 V.

INSULATION COMPLIANT WITH IEC-60900

- Length: 210 mm.
- Weight: 0.190 Kg.

Ref.

MO-66105

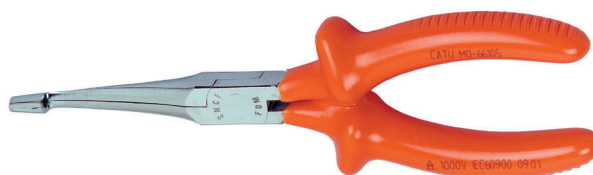

Plug-out plier MO66200

The plier MO66200 allows the easy plug-out red and blue disconnects terminals of 2.8, 4.7, 5 and 6.35 mm. The specific design of the noses allows plug-out same in difficult area or limited space. It avoid all risk of damage on disconnects.

- Polished steel body.
- PVC insulated handles.
- Length: 170 mm.
- Weight: 0.150 kg.

Ref.

MO66200

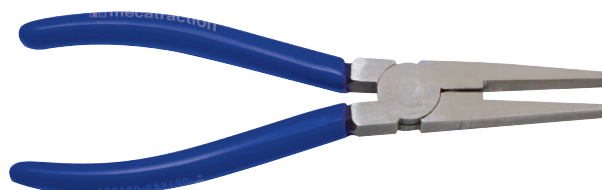

Cordless Electro-mechanical Cable-cutter

ESK50 Electro-mechanical Cable-cutter

- New powerful motor with high torque offers superior performances
- New ergonomics for ease of operation during cable cutting. The new handle orientation gives a better arm position.
- New circuit board which shuts down for overloading protection.
- Cutting capacity up to Ø 50 mm:
- Cutting capacity Cu: 400 mm².
- Cutting capacity Al: 630 mm².
- Cycle time: 3 to 6 s depending on cable.
- Autonomy: 60 to 75 cuts with 5.0 Ah.

Caution: never use for cutting cables with steel strip protection or for cables with steel core

- Dimensions (battery included): 400 x 150 x 110 mm.
- Weight (battery included): 2.950 Kg.

Ref.

ESK50K1BLCP

Kit composition:

- 1 electro-mechanical cable-cutter.
- 2 batteries 18V / 5.0 Ah.
- 1 charger.
- 1 plastic box.

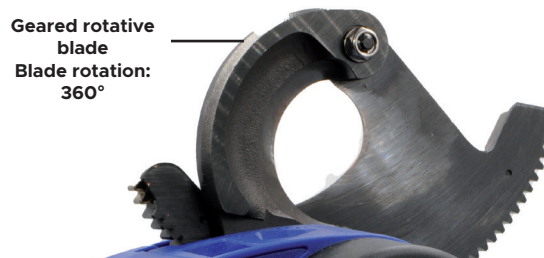

Geared rotative blade
Blade rotation: 360°

Advance and retract command with safety lock

Equipped with a circuit-breaker to protect against the cutting of a cable larger than tool capacity



Electric motor transmission with epicycloidal gearbox

Additional equipment for ESK50:

Battery

- Li-Ion battery: 18V/5.0 Ah.
- Battery equipped with an integrated electronic circuit.
- Li-Ion technology without memory effect.
- Weight: 0.570 kg.

Ref.

BL1850B



Fast charger

- Charger with display which identifies the state of the battery and the conditions of load.
- Charging time: 36 min.
- Weight: 0.85 Kg.
- Voltage: 220-240 V AC.
- Plug: Standard EU, others on request.

Ref.

CLM1890HC



Number of crimps per tool

HEXAGONAL CRIMPING

	PMM1CF ESD50 EID51		TR1461		TR1462		ESU137		VF130K		VF210K	
	50 kN	Nbr*	55 kN	Nbr*	100 kN	Nbr*	120 kN	Nbr*	130 kN	Nbr*	200 kN	Nbr*
ELP			x	1	x	1	x	1				
FLP			x	1	x	1	x	1				
NP			x	1	x	1	x	1				
ELS	x	1	x	1	x	1	x	1	x	1	x	1
FLS	x	1	x	1	x	1	x	1	x	1	x	1
TN25	x	1	x	1	x	1	x	1	x	1	x	1
TN35	x	1	x	1	x	1	x	1	x	1	x	1
TN50	x	1	x	1	x	1	x	1	x	1	x	1
TN60	x	1	x	1	x	1	x	1	x	1	x	1
TN70	x	1	x	1	x	1	x	1	x	1	x	1
TN95			x	1	x	1	x	1	x	1	x	1
TN120							x	1	x	1	x	1
TN150							x	1	x	1	x	1
TN185							x	1			x	1
TN240							x	2			x	2
TN300											x	2
AL50							x	1	x	1	x	1
AL60							x	1	x	1		
AL70							x	1	x	1	x	1
AL95							x	1	x	1	x	1
AL120											x	1
AL150											x	1
AL185											x	2
AL240											x	2
AL300											x	2
AL460											x	2

*number of crimps to be made.

B CRIMPING

	ESU137		VF210K + S21	
	120 kN	Nbr*	200 kN	Nbr*
ELS	x	1		
FLS	x	1		
TN25	x	1		
TN35	x	1		
TN50	x	1		
TN60	x	1		
TN70	x	1		
TN95	x	1		
TN120	x	1		
TN150			x	2
TN185			x	2
TN240			x	2
TN300			x	2

*number of crimps to be made.

Checking your crimping dies

Go-no-go gauge

Gauges for diagnosing the wear of your crimping dies.

Gauge for tools

	Ref. of the gauge
TH1 - TH1S - TH1-90 - ET331	PG1
TH2 - TH2S - ET332	PG2
TH3 - TH3-2 - ET333 - ET333-2	PGH3
PMM1CF	PGM1

Gauge for hexagonal dies

	Ref. of the gauge
ELP	PGP10
FLP	PGP16
NP	PGP25
ELS	PGN10
FLS	PGN16
TN25	PGTN25
TN35	PGTN35
TN50	PGTN50
TN60	PGTN60
TN70	PGTN70
TN95	PGTN95
TN120	PGTN125
TN150	PGTN150
TN185	PGTN185
TN240	PGTN240
TN300	PGTN300



NEW

This documentation is not contractual. The products shown are subject to availability.
Mecatraction reserves the right to discontinue production or to change specifications without prior notice.

Non contractual photos
All rights of reproduction, adaptation and translation reserved for all countries.

Photos credits : 123RF.com. ©halfpoint. ©nikitos77. ©denisbelitsky. ©pressfoto. ©metlion.

Our location



MECATRACTION

● sicame-group.com

sicame
GROUP



MECATRACTION
ZA Les Hauts de Chignac 19230 Arnac-Pompadour
Tel: +33 (0)5 55 73 89 89
E-mail : info@mecatraction.com
mecatraction.com

